

1982

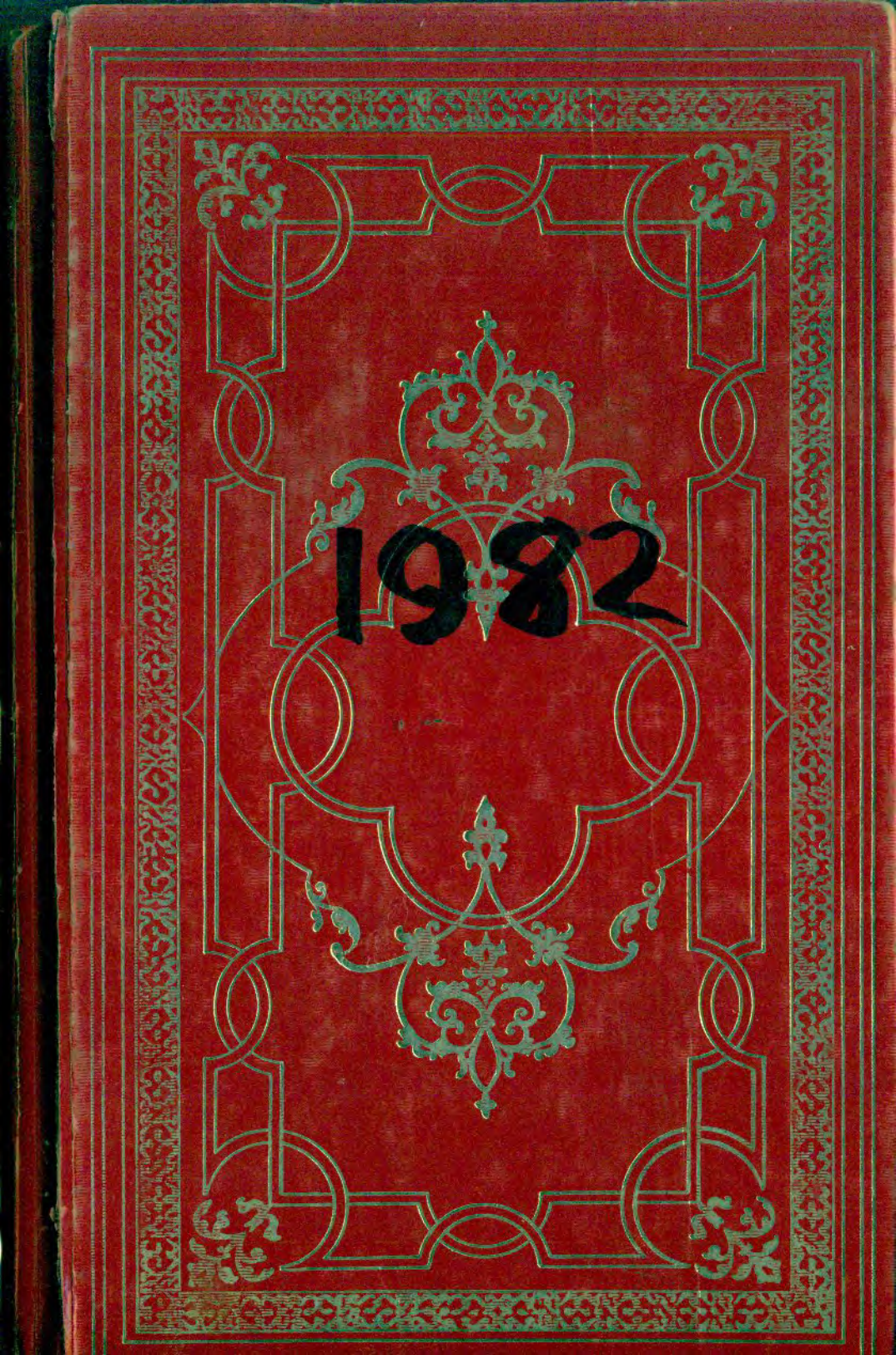

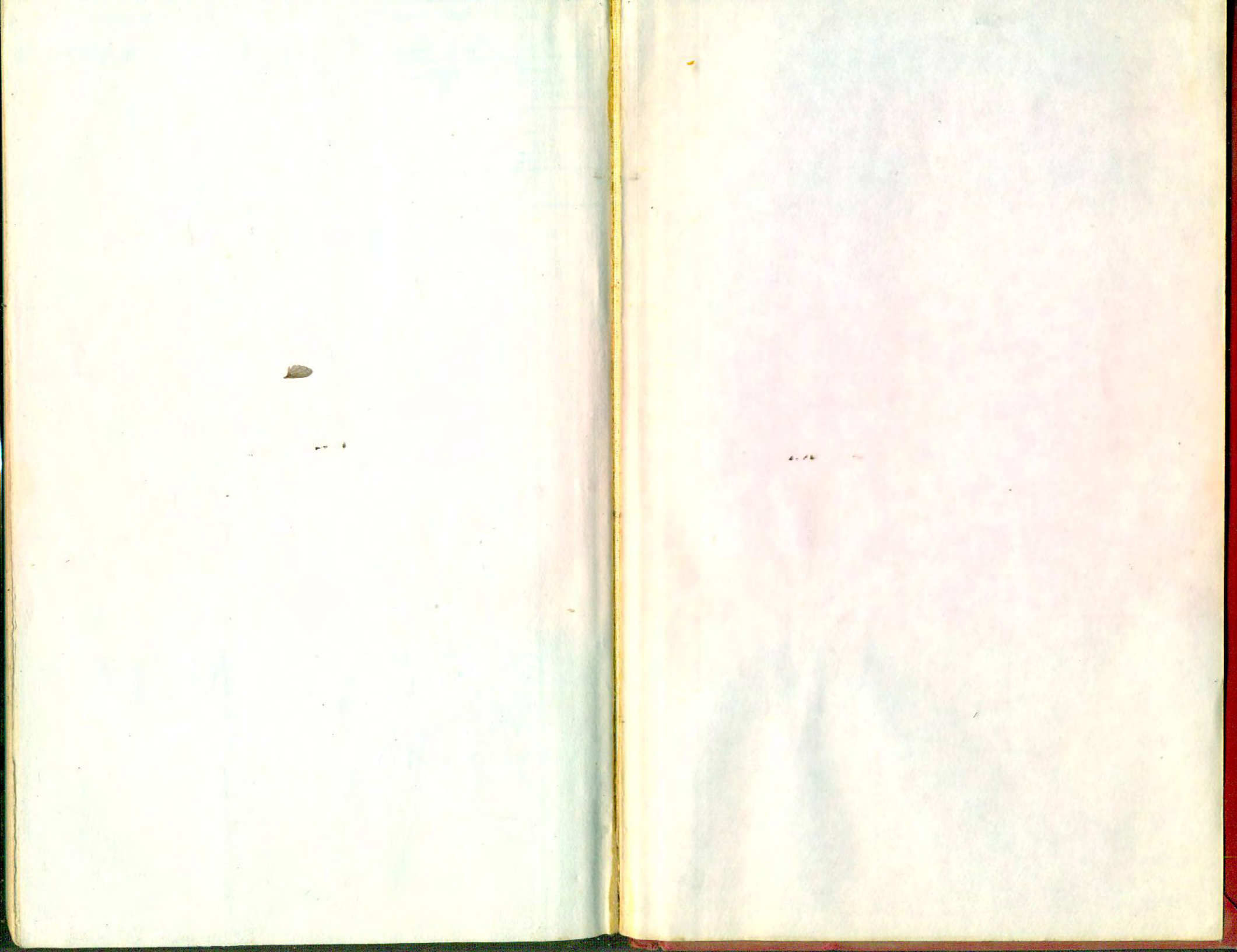



U.S. Dept of the Interior. Geological Survey.

SELECTED LANDSAT COVERAGE MAP

Infrared colour

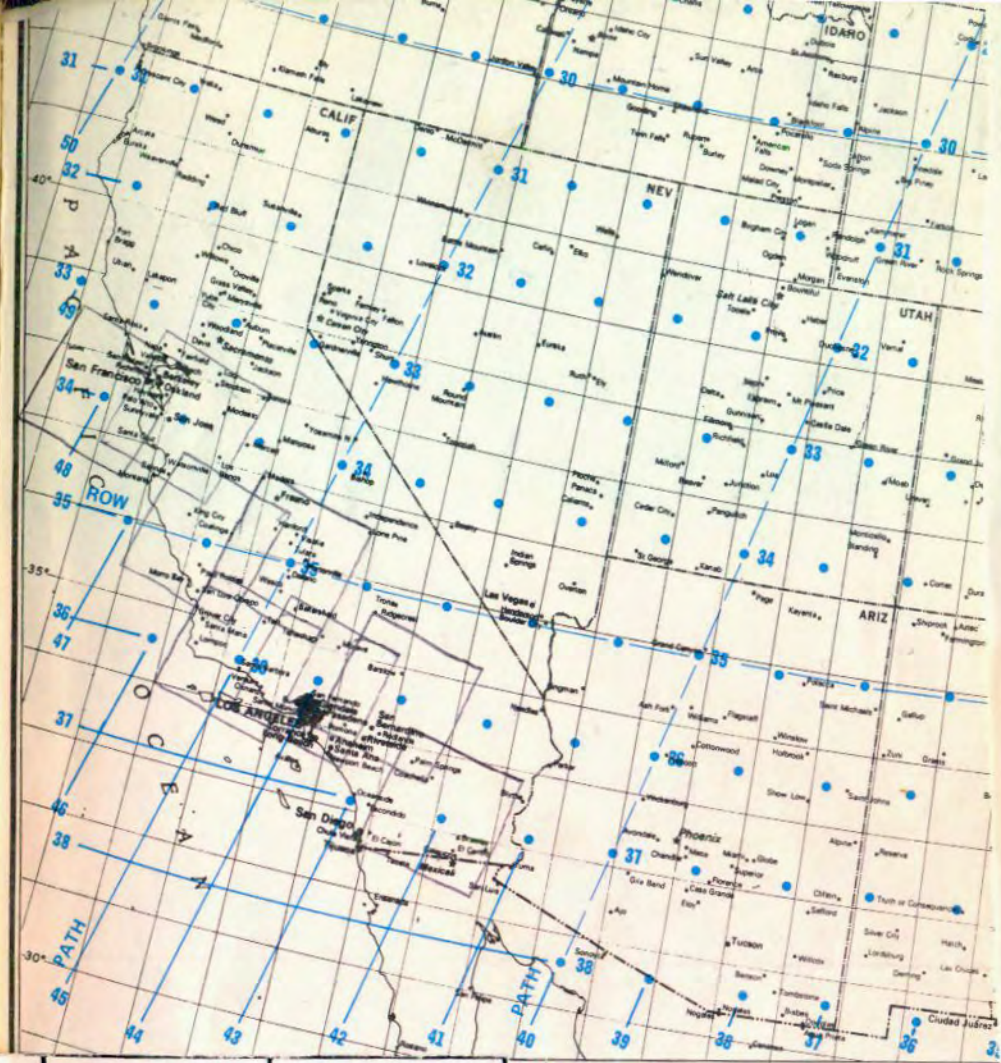

NOMINAL IMAGE SIZE	PRODUCT MATERIAL	BLACK & WHITE UNIT PRICE	PRODUCT CODE	COLOR UNIT PRICE	PRODUCT CODE
55.8mm (2.2 in.)	Film Positive	\$ 8.00	11	NA	NA
55.8mm (2.2 in.)	Film Negative	\$10.00	01	NA	NA
18.5cm (7.3 in.)	Paper	\$10.00	23	\$15.00	63
18.5cm (7.3 in.)	Film Positive	\$10.00	13	\$25.00	53
18.5cm (7.3 in.)	Film Negative	\$12.00	03	NA	NA
37.1cm (14.6 in.)	Paper	\$20.00	24	\$35.00	64
74.2cm (29.2 in.)	Paper	\$35.00	26	\$70.00	66

Scale 1:1,000,000

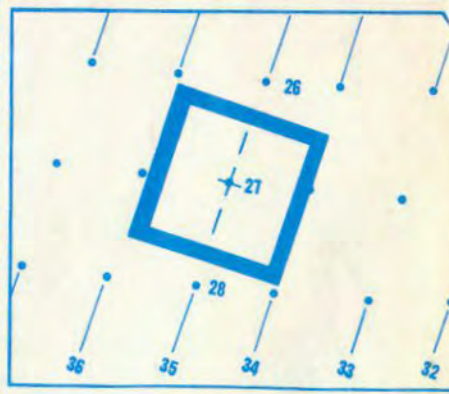

EXAMPLE OF TEMPLAT

Map Reference Point 35-27
(Path 35 Row 27)



COVERAGE TEMPLATE

Inside Dimensions Reflect Actual Coverage

☆U.S. Government Printing Office: 1979—667-335

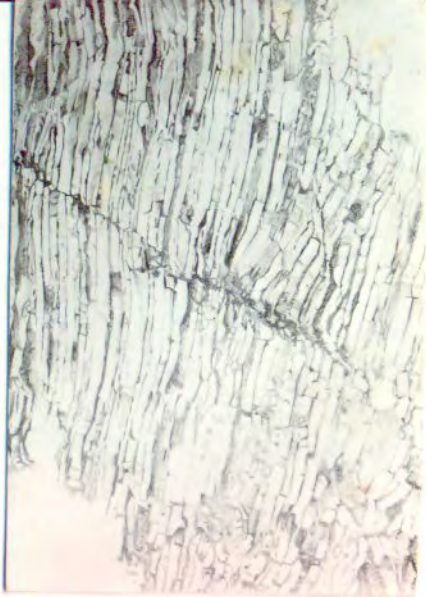

Black/white ortho photos.
Scale 1:24000.

on mylar \$22.00

on photo
paper \$8-50.

on diazo \$2-00. $\frac{1}{2}$ tone 133/inch.
paper

collected from: US Geological Survey.
Western Mapping Center.
345 Middlefield Rd.
Menlo Park CA 94025.
Ph. (415) 323-8111.

8 Landsat sheets @ \$35 = \$280.

Smaller 8,

@

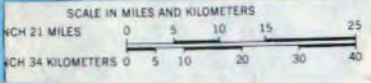

How to read your map of CALIFORNIA

- MILEAGES** LONG DISTANCE MILEAGES SHOWN IN RED
- MILEAGE BETWEEN TOWNS AND JUNCTIONS
 - MILEAGE BETWEEN DOTS
 - ONE MILE EQUALS 1.6 KILOMETERS
 - ONE KILOMETER EQUALS .6 MILES
 - SPECIAL FEATURES
 - POINTS OF INTEREST
 - STATE PARK PROPERTIES
 - SCHEDULED AIRLINE STOPS



Closed Mon. & Tues.

California Valley

Restaurant, Bar and Gas Station

Motel (805) 475-2261
Rest. (805) 475-2363

Manager
Elvin & Nita
Carter



DONALD J. STIERMAN
 Assistant Research Geophysicist
 Institute of Geophysics and Planetary Physics

UNIVERSITY OF CALIFORNIA
 Riverside, California 92521

Area Code 714
 787-3438

GROWING INSTRUCTIONS
FOR SAGUARO SEEDS

Saguaros may be grown indoors. When properly cared for they can grow at the rate of 1" or more per year. Some saguaros in natural settings have reached heights of 50' and ages over 150 years.

1. Fill a suitable pot (with drainage) to within 1" of top with clean, sandy soil.
2. Thoroughly wet and allow soil to drain.
3. Sprinkle seeds on the surface.
4. DO NOT COVER SEEDS WITH SOIL-- LIGHT IS NECESSARY FOR GERMINATION.
5. Place pot in warm (not hot) lighted location but out of direct sunlight. Cover pot with clear plastic or glass.
6. Keep moist but do not flood.
7. Remove plastic after 14-18 days. Transplant as desired when $\frac{1}{2}$ " high.

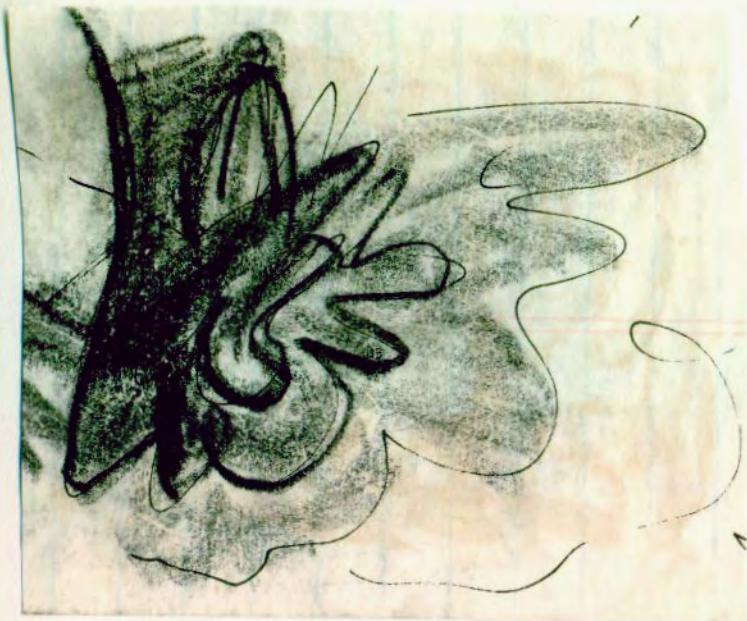

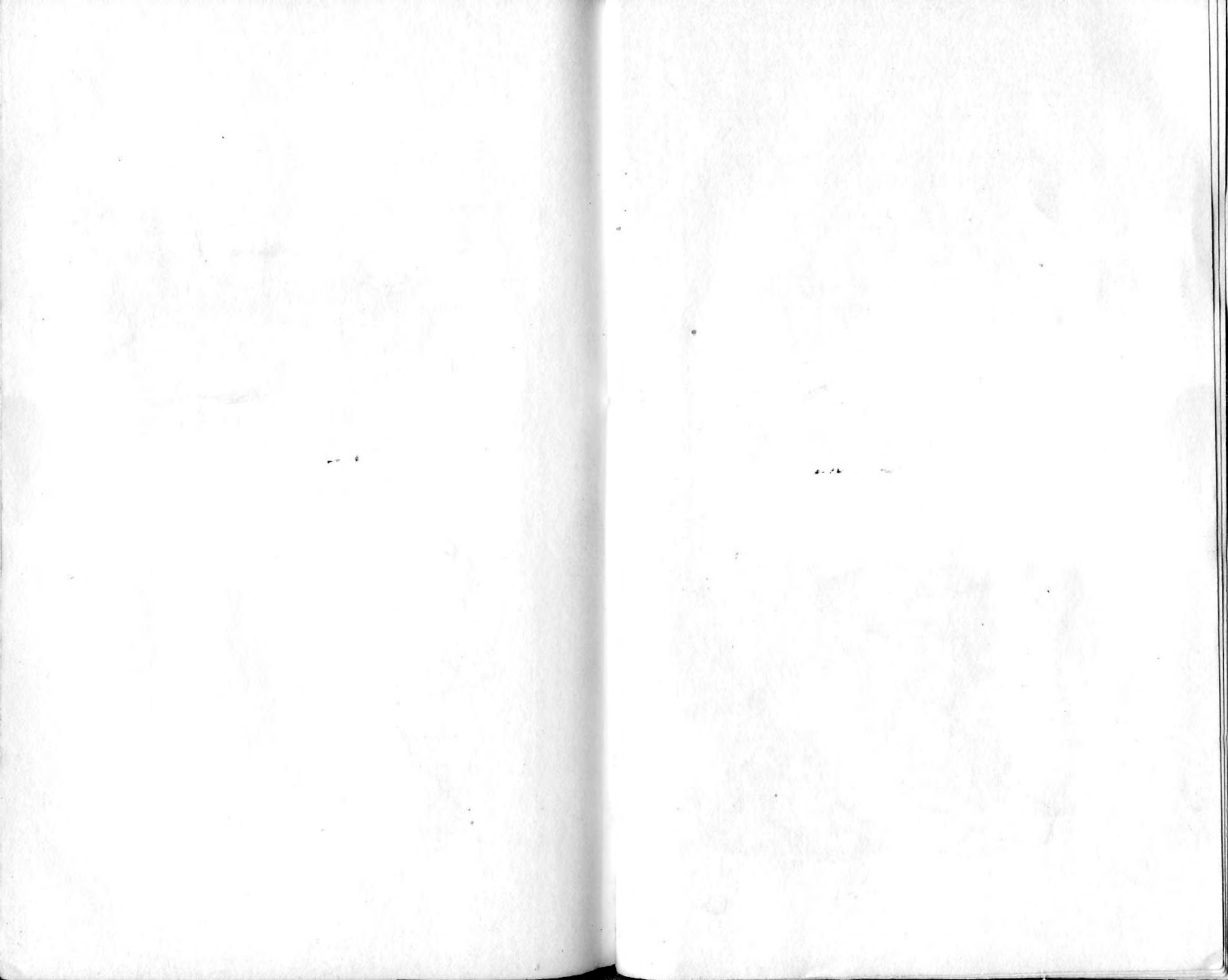



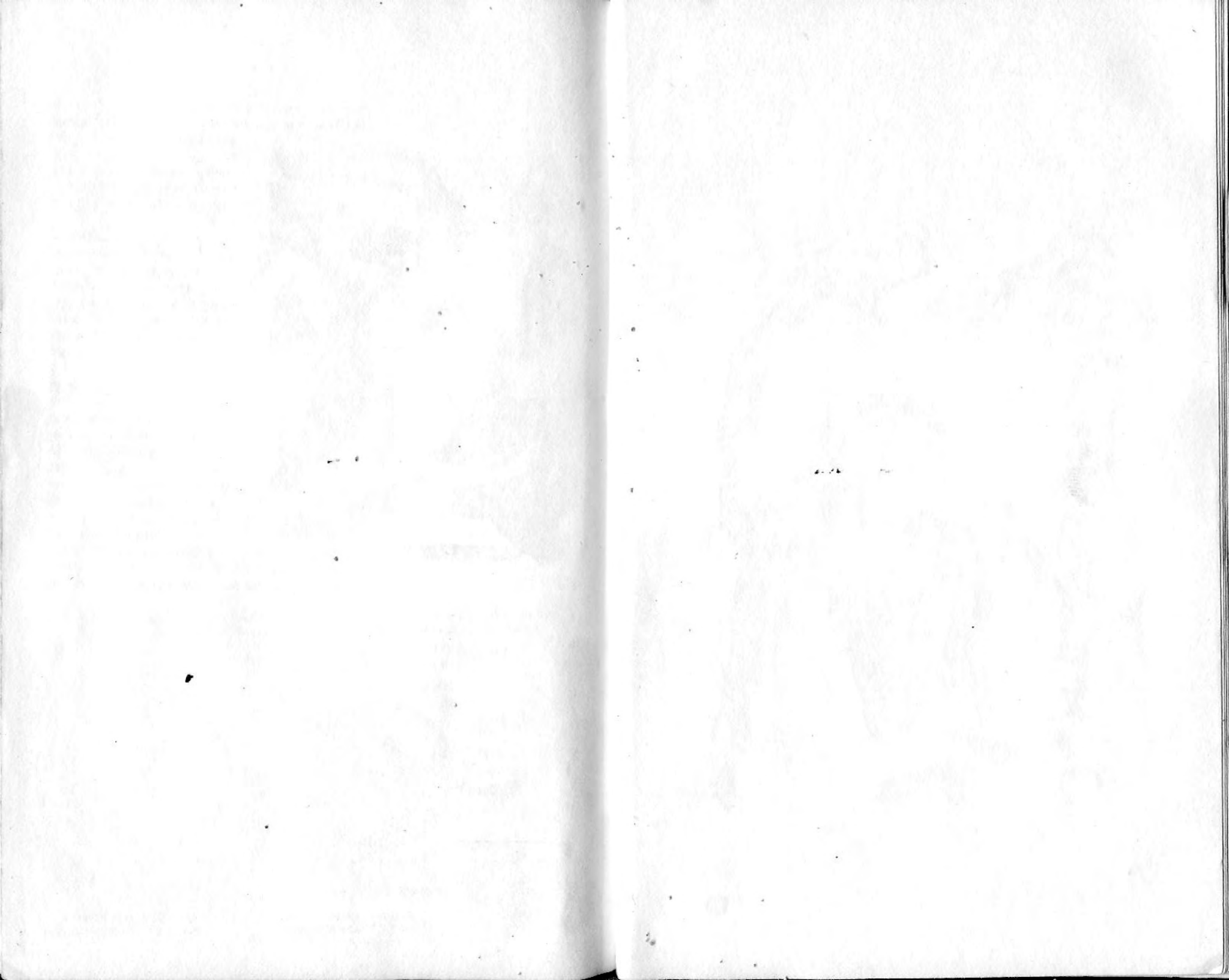

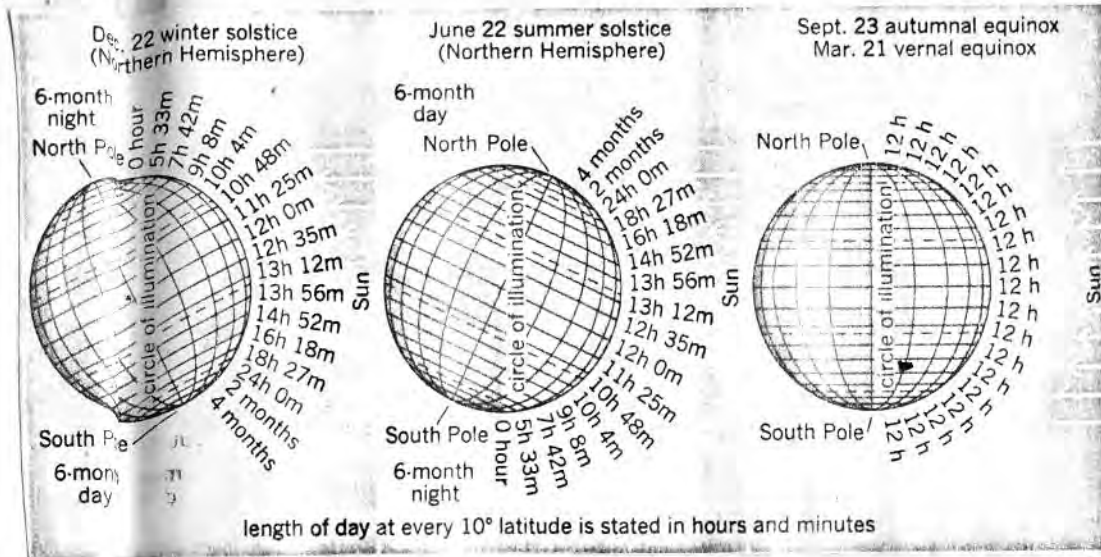

Seasons. From June 21, when the Sun's rays are vertical at the Tropic of Cancer (summer solstice), summer continues in the Northern Hemisphere until Sept. 23, when the Sun's rays strike directly over the Equator (autumnal equinox) (Fig. 2). During this period (and during the spring) the Sun at the North Pole will be at or above the horizon at all times. All places north of the Equator will have longer days than nights, and the Northern Hemisphere will receive its maximum solar insolation. Similar summer conditions will be found during December, January, and February at the South Pole and throughout the Southern Hemisphere. Fall begins with the Sun overhead at the Equator and continues until Dec. 22 (winter solstice), when the Sun has reached its southern zenithal position at the Tropic of Capricorn, $23\frac{1}{2}^\circ$ south. Winter finds the overhead Sun's rays moving back toward the Equator, which is attained on Mar. 21 (vernal equinox). During the fall and winter, days in the Northern Hemisphere will be shorter than the nights, and the Sun will drop to its lowest angle above the horizon. Spring is that period when the Sun is again overhead north of the Equator, from Mar. 21 to June 21. See EQUINOX: NORTH POLE: SOLSTICE: SOUTH POLE.

Axial inclination and parallelism. The positions and changes of the Earth's axis are most important factors in Earth-Sun relationships. As the Earth moves through its orbit, the axis of rotation is constantly inclined at about $66\frac{1}{2}^\circ$ ($66^\circ 55'$) from the plane of the ecliptic, or $23\frac{1}{2}^\circ$ ($23^\circ 45'$) from a line perpendicular to the ecliptic. In addition to maintaining its inclination with the ecliptic, the polar axis of rotation always points to the same spot in the heavens throughout its yearly revolution around the Sun. Thus, there is always parallelism of the axis at all points in the orbit. Precessional motion is not considered here. See PRECESSION OF EQUINOXES.

Because of the inclination and parallelism the north polar part of the axis will, on 1 day of the year, Dec. 22, be tilted $23\frac{1}{2}^\circ$ away from the Sun; 6 months later, on June 21, it will be tilted $23\frac{1}{2}^\circ$ toward the Sun. On the 2 days midway between these extremes, Mar. 21 and Sept. 23, the North Pole will not tilt toward or away from the Sun, but the axis will make a 90° angle with a line drawn to the Sun.

Thus it can be seen that the vertical rays of the Sun (at noon in all cases cited) will continually change position and move through a latitudinal span of 47° , from the Tropic of Cancer $23\frac{1}{2}^\circ$ north to the Tropic of Capricorn $23\frac{1}{2}^\circ$ south. This progression of the vertical rays of the Sun is the basis for the seasons on Earth.

TABLE 3(1) True bearing of sun at sunrise and sunset.

LAT	DECLINATION											LAT	
	0°	1°	2°	3°	4°	5°	6°	7°	8°	9°	10°		11°
30°	90	88.8	87.7	86.5	85.4	84.2	83.1	81.9	80.7	79.6	78.4	77.3	30°
31°	90	88.8	87.7	86.5	85.3	84.2	83.0	81.9	80.6	79.5	78.3	77.1	31°
32°	90	88.8	87.6	86.5	85.3	84.1	82.9	81.7	80.5	79.4	78.2	77.0	32°
33°	90	88.8	87.6	86.4	85.2	84.0	82.8	81.6	80.4	79.2	78.0	76.8	33°
34°	90	88.8	87.6	86.4	85.2	84.0	82.7	81.5	80.3	79.1	77.9	76.7	34°
35°	90	88.8	87.5	86.3	85.1	83.9	82.7	81.4	80.2	79.0	77.8	76.5	35°
36°	90	88.8	87.5	86.3	85.0	83.8	82.6	81.3	80.1	78.8	77.6	76.3	36°
37°	90	88.7	87.5	86.2	85.0	83.7	82.5	81.2	80.0	78.7	77.4	76.2	37°
38°	90	88.7	87.5	86.2	84.9	83.6	82.4	81.1	79.8	78.5	77.3	76.0	38°
39°	90	88.7	87.4	86.1	84.8	83.6	82.3	81.0	79.7	78.4	77.1	75.8	39°
40°	90	88.7	87.4	86.1	84.8	83.5	82.1	80.8	79.5	78.2	76.9	75.6	40°
41°	90	88.7	87.3	86.0	84.7	83.4	82.0	80.7	79.4	78.0	76.7	75.3	41°
42°	90	88.6	87.3	86.0	84.6	83.3	81.9	80.6	79.2	77.8	76.5	75.1	42°
43°	90	88.6	87.3	85.9	84.5	83.1	81.8	80.4	79.0	77.6	76.3	74.9	43°
44°	90	88.6	87.2	85.8	84.4	83.0	81.6	80.2	78.8	77.4	76.0	74.6	44°
45°	90	88.6	87.2	85.7	84.3	82.9	81.5	80.1	78.6	77.2	75.8	74.3	45°
46°	90	88.6	87.1	85.7	84.2	82.8	81.3	79.9	78.4	77.0	75.5	74.0	46°
47°	90	88.5	87.1	85.6	84.1	82.6	81.2	79.7	78.2	76.7	75.2	73.7	47°
48°	90	88.5	87.0	85.5	84.0	82.5	81.0	79.5	78.0	76.5	75.0	73.4	48°
49°	90	88.5	86.9	85.4	83.9	82.4	80.8	79.3	77.7	76.2	74.6	73.1	49°
50°	90	88.4	86.9	85.3	83.8	82.2	80.6	79.1	77.5	75.9	74.3	72.7	50°
51°	90	88.4	86.8	85.2	83.6	82.0	80.4	78.8	77.2	75.6	74.0	72.4	51°
52°	90	88.4	86.7	85.1	83.5	81.9	80.2	78.6	76.9	75.3	73.6	71.9	52°
53°	90	88.3	86.7	85.0	83.3	81.7	80.0	78.3	76.6	74.9	73.2	71.5	53°
54°	90	88.3	86.6	84.9	83.2	81.5	79.8	78.0	76.3	74.6	72.8	71.1	54°
55°	90	88.2	86.5	84.8	83.0	81.3	79.5	77.7	76.0	74.2	72.4	70.6	55°
56°	90	88.2	86.4	84.6	82.8	81.0	79.2	77.4	75.6	73.8	71.9	70.0	56°
57°	90	88.2	86.3	84.5	82.6	80.8	78.9	77.0	75.2	73.3	71.4	69.5	57°
58°	90	88.1	86.2	84.3	82.4	80.5	78.6	76.7	74.8	72.8	70.9	68.9	58°
59°	90	88.1	86.1	84.2	82.2	80.3	78.3	76.3	74.3	72.3	70.3	68.3	59°
60°	90	88.0	86.0	84.0	82.0	80.0	77.9	75.9	73.8	71.8	69.7	67.6	60°

LAT	DECLINATION											LAT	
	12°	13°	14°	15°	16°	17°	18°	19°	20°	21°	22°		23°
30°	76.1	74.9	73.8	72.6	71.4	70.3	69.1	67.9	66.7	65.5	64.4	63.2	30°
31°	76.0	74.8	73.6	72.4	71.2	70.0	68.9	67.7	66.5	65.3	64.1	62.9	31°
32°	75.8	74.6	73.4	72.2	71.0	69.8	68.6	67.4	66.2	65.0	63.8	62.6	32°
33°	75.6	74.4	73.2	72.1	70.8	69.6	68.4	67.1	65.9	64.7	63.5	62.2	33°
34°	75.5	74.2	73.0	71.8	70.6	69.3	68.1	66.9	65.6	64.4	63.1	61.9	34°
35°	75.3	74.1	72.8	71.6	70.3	69.1	67.8	66.6	65.3	64.1	62.8	61.5	35°
36°	75.1	73.8	72.6	71.3	70.1	68.8	67.5	66.3	65.0	63.7	62.4	61.1	36°
37°	74.9	73.6	72.4	71.1	69.8	68.5	67.2	65.9	64.6	63.3	62.0	60.7	37°
38°	74.7	73.4	72.0	70.8	69.5	68.2	66.9	65.6	64.3	62.9	61.6	60.3	38°
39°	74.5	73.2	71.9	70.5	69.2	67.9	66.6	65.2	63.9	62.5	61.2	59.8	39°
40°	74.2	72.9	71.6	70.2	68.9	67.6	66.2	64.8	63.5	62.1	60.7	59.3	40°
41°	74.0	72.7	71.3	69.9	68.6	67.2	65.8	64.4	63.0	61.6	60.2	58.8	41°
42°	73.7	72.4	71.0	69.6	68.2	66.8	65.4	64.0	62.6	61.2	59.7	58.3	42°
43°	73.5	72.1	70.7	69.3	67.9	66.4	65.0	63.6	62.1	60.7	59.2	57.7	43°
44°	73.2	71.8	70.3	68.9	67.5	66.0	64.6	63.1	61.6	60.1	58.6	57.1	44°
45°	72.9	71.4	70.0	68.5	67.0	65.6	64.1	62.6	61.1	59.5	58.0	56.4	45°
46°	72.6	71.1	69.6	68.1	66.6	65.1	63.6	62.0	60.5	58.9	57.4	55.8	46°
47°	72.2	70.7	69.2	67.7	66.2	64.6	63.1	61.5	59.9	58.3	56.7	55.0	47°
48°	71.9	70.3	68.8	67.2	65.7	64.1	62.5	60.9	59.3	57.6	55.9	54.3	48°
49°	71.5	69.9	68.4	66.8	65.1	63.5	61.9	60.2	58.6	56.9	55.2	53.4	49°
50°	71.1	69.5	67.9	66.2	64.6	62.9	61.3	59.6	57.8	56.1	54.3	52.6	50°
51°	70.7	69.1	67.4	65.7	64.0	62.3	60.6	58.8	57.1	55.3	53.5	51.6	51°
52°	70.3	68.6	66.9	65.1	63.4	61.6	59.9	58.1	56.3	54.4	52.5	50.6	52°
53°	69.8	68.1	66.3	64.5	62.7	60.9	59.1	57.3	55.4	53.5	51.5	49.5	53°
54°	69.3	67.5	65.7	63.9	62.0	60.2	58.3	56.4	54.4	52.4	50.4	48.3	54°
55°	68.7	66.9	65.1	63.2	61.3	59.4	57.4	55.4	53.4	51.3	49.2	47.1	55°
56°	68.2	66.3	64.4	62.4	60.5	58.5	56.5	54.4	52.3	50.1	47.9	45.7	56°
57°	67.6	65.6	63.6	61.6	59.6	57.5	55.4	53.3	51.1	48.9	46.5	44.2	57°
58°	66.9	64.9	62.8	60.8	58.7	56.5	54.3	52.1	49.8	47.4	45.0	42.5	58°
59°	66.2	64.1	62.0	59.8	57.6	55.4	53.1	50.8	48.4	45.9	43.3	40.7	59°
60°	65.4	63.3	61.1	58.8	56.5	54.2	51.8	49.4	46.8	44.2	41.5	38.6	60°

Precession of equinoxes

A slow change in the direction of orientation of Earth's axis of rotation which results in a gradual westward motion of the equinoxes. There are two types, known as lunisolar precession and planetary precession. The total precession is the sum of these two. The phenomenon of lunisolar precession, which is by far the more important, was discovered by Hipparchus about 125 B.C., and was first explained by Isaac Newton.

The term equinox has a dual meaning. It refers to (1) either of the two imaginary points at which the ecliptic (the apparent annual path of the Sun among the stars) crosses the celestial equator (the great circle in which the plane of Earth's equator intersects the celestial sphere), or (2) the date when such a crossing occurs. During its annual journey around the ecliptic the Sun crosses the celestial equator twice. There are therefore two equinoxes each year; the vernal equinox occurs about March 21, and the autumnal equinox occurs about September 23. The annual westward motion of the equinoxes caused by precession amounts to about $50''/27$. The general motion of Earth's axis of rotation consists of precession plus a second angular motion of the axis which is called nutation. For general discussions of these phenomena see NUTATION (ASTRONOMY AND MECHANICS); PRECESSION. See also ASTRONOMICAL COORDINATE SYSTEMS; EARTH, ROTATION AND ORBITAL MOTION OF.

Physical causes. The lunisolar precession of the equinoxes is caused by the gravitational attraction of the Sun and the Moon which, as a result of the polar flattening of Earth and the inclination of Earth's axis, gives rise to a small turning moment, or torque, on the Earth in its orbit (Fig. 1). This torque is not constant because of the varying positions in space of the three bodies involved. Because of the closer distance of the Moon, the magnitude of the torque due to the Moon is greater than that due to the Sun. As a result of this torque, Earth's axis describes a cone about the normal to the plane of its orbit (Fig. 2); the period of this precession is approximately 26,000 years in a direction opposite to that of Earth's rotation; that is, the equinoxes precess from east to west.

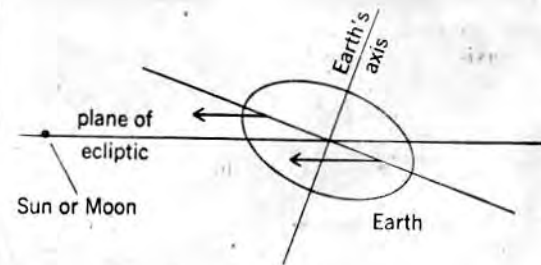

Fig. 1. Gravitational attraction of Sun or Moon on Earth. A torque results which tends to tip Earth's axis.

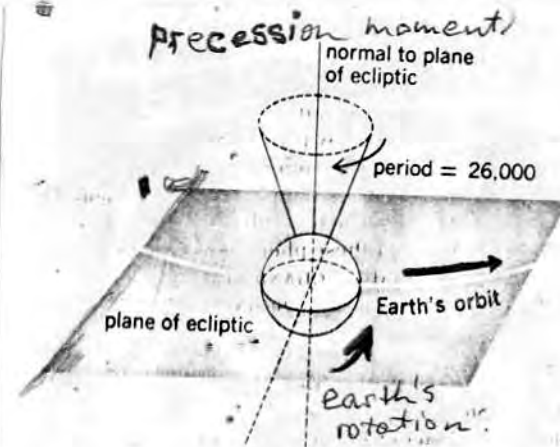

Fig. 2. Conical motion of Earth's axis. One complete cycle of precession requires 26,000 years.

B+Breakfast / room as studio in Bognor.

Mr. and Mrs. Eric Norton

"Twig",
233 Aldwick Road,
Bognor Regis.

Bognor 822627

Paton Gallery
2 Langley Court Long Acre
London WC 2

Graham Paton

01 379 7854

Possible
galley to
hold my
prints
after New
House Show

W. R. Beaver

PUBLIC RELATIONS OFFICER

New South Wales Government
66 Strand, London, WC2N 5LZ

Tel. 01-839 6651

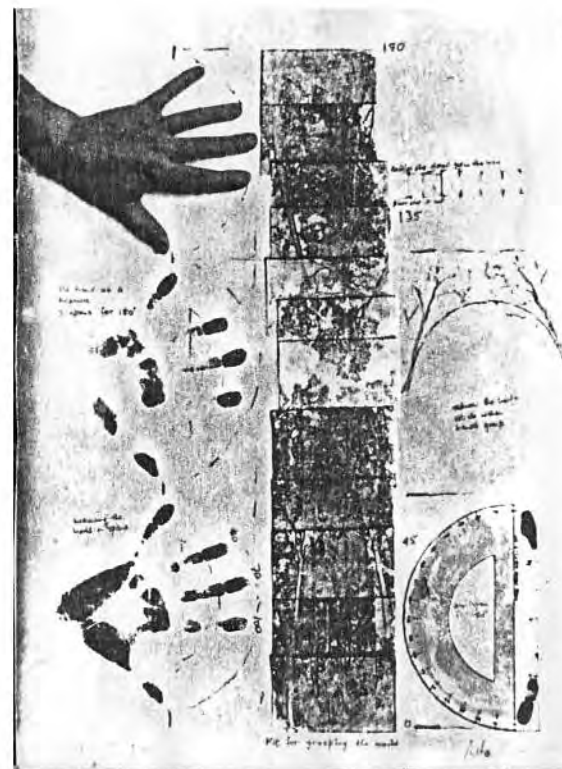

66

GALERIE BAMA

NINON ROBELIN

40 RUE QUINCAMPOIX, 75004 PARIS

TÉL. 277.38.87

Showed prints & drawings to
Ninon Robelin in Feb. '82.
& left documentation with her.

She will let me know if she is
wanting me to send work for a
group show.

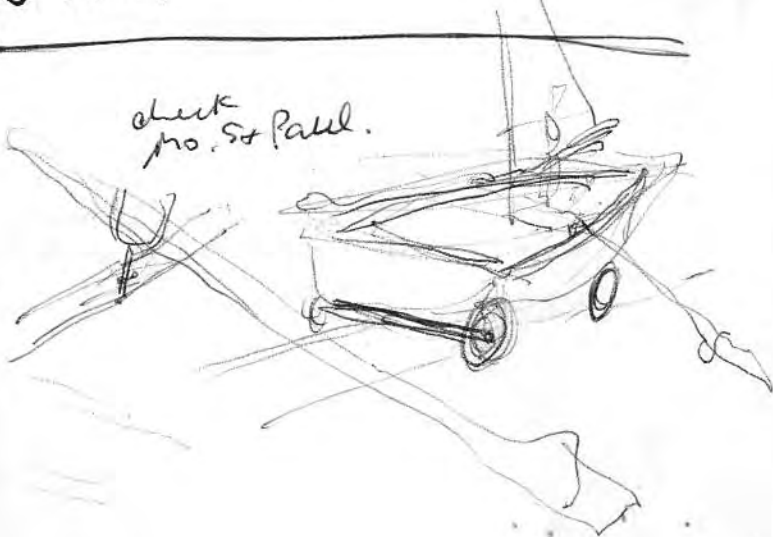

Galerie Lucie Weill
6 rue Bonaparte 75006
354-71-95.

Philippe Labanthe.

Evelyn.

PARIS
ACCUEIL

Hébergement
chez l'Habitant
Bed and
Breakfast Office

☎ 296 14 26
ou 256 37 47

Rue de Marignan, 23
75008 PARIS

Agfa - Gevaert.
13 Blvd Henri Sellier.
92150 Suresnes.
Tel. 772-10.18.

to borrow recording apparatus.
Saturday.

FNAC. (les Halles.)
(Moutonmasson).
for cheap.
1/2" mag tape.

4 March

State of the work

Drawings "Completed"

From the Tidal Equinox actions:
I'm still pulling images together.
& pushing old ones around.

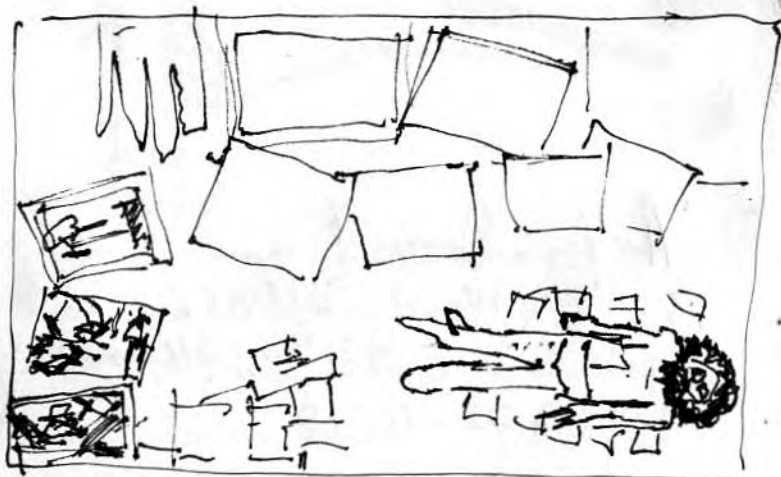

'Flotsam from High Tide'

+ small drawings from the placing
of the Sand Memory capsules in the
3 sites

With slides of the 3 "site" drawings,
could make colour Xerox copies
as transfers.

~~Paris Paper.~~
~~54 Bud. Eastern~~
~~10²~~
Ph. 322-93-60.

10 March.

More images from San Andreas.

Have developed a series of drawings.



Cholame

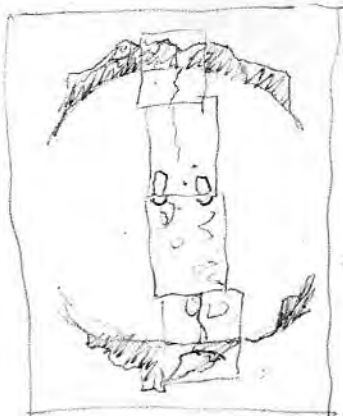

Santa Anna wash.

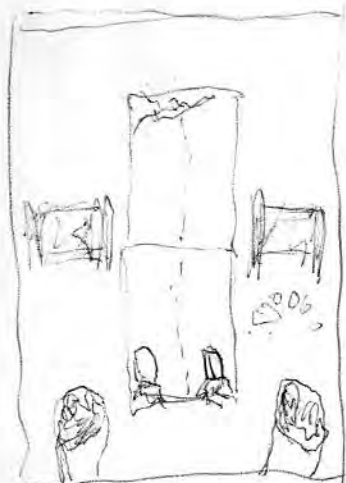

Point Reyes

From the Image of the
fractured rock face (photo taken
at Parkfield.)

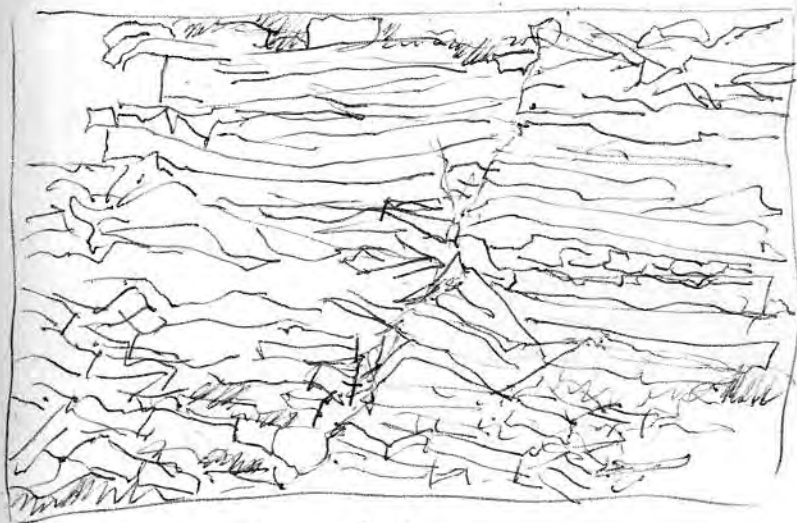

Parkfield

Have made 3 positive
lith transparencies ($> 30'' \times 22''$) in order to
print a series of silkscreen images
in 3 separate colours progressively built
up viz.

- ① most detail
- ② middle detail
- ③ least detail
(like a line drawing).

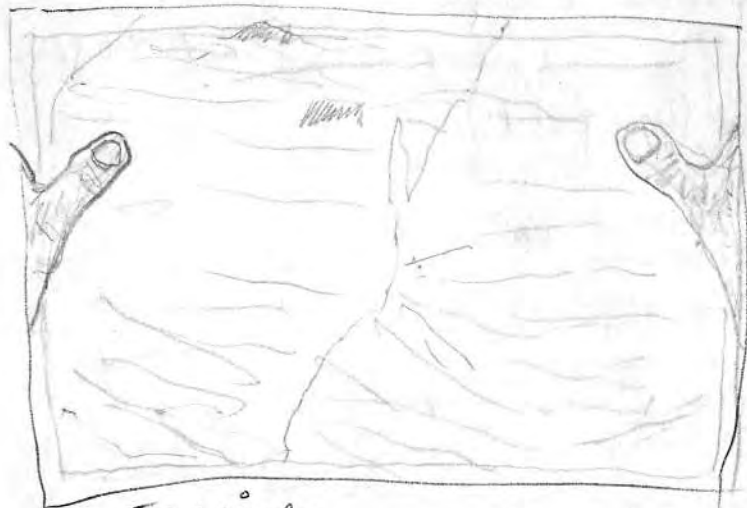

Tearing
Holding an image
of the San Andreas.

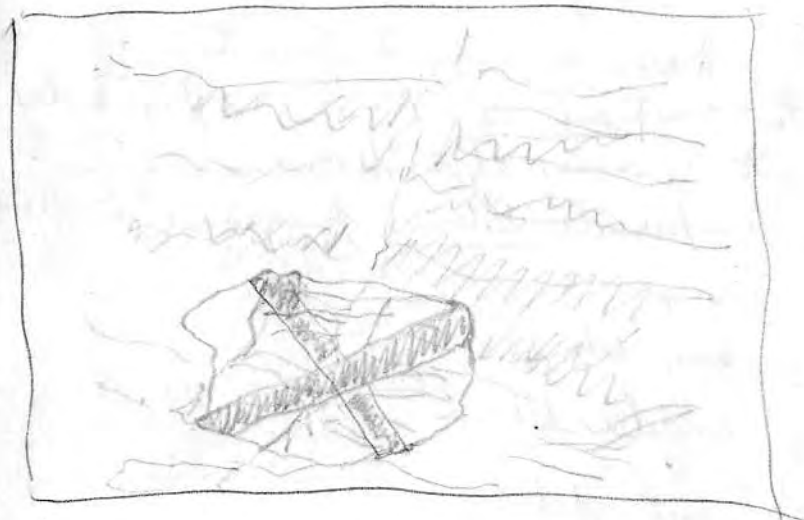

Bandaged rock

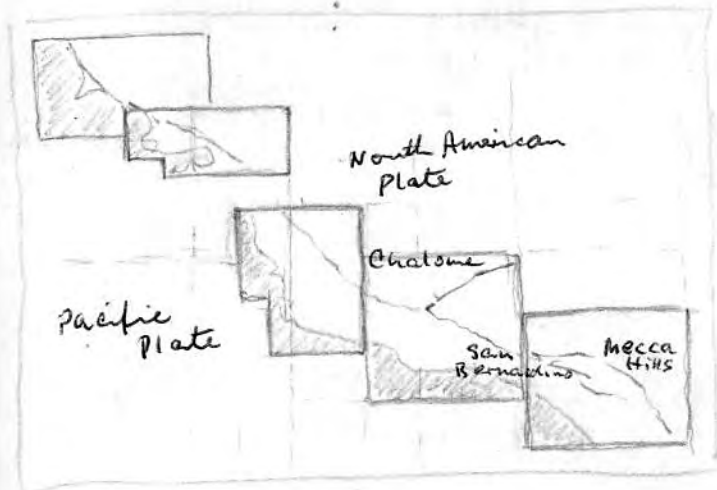

Working fragment for Earth Slip.
earth sliding against earth.

Use the body as a bearing to
help the earth creep.
measure this creep } by foot.
slide

1857	San Gabriel mtns.	350 Km.
1838	San Francisco	400 Km.
1868	Salton Sea	20 Km.
1890	* Hollister.	30 Km.
1901	Parkfield Trembler range	20 Km.
1906	San Francisco	400 Km.
1916	Wrightwood	5 Km.
1922	Parkfield Trembler range	20 Km.
1934	Parkfield Trembler range	20 Km.
1966	Parkfield Trembler range	30 Km.

* San Juan Batista.

25 March.

- ① Photocopies. (x10).
- ② Buy paper. - Arches 88 (x100) 56x76.
- Arches blanc (x50) 80x120
- ③ Darkroom - hands. ^{Kodolith.} Small rock face.
- ④ Organic silk screening.
- San Andreas

Photocopies.

- Bob Gray. *
- Texas. *
- Suzanne Papé. *
- ...

4000
60
800
60

Notes on photo transparencies
for Earth slip.



reduce 2nd. & a.

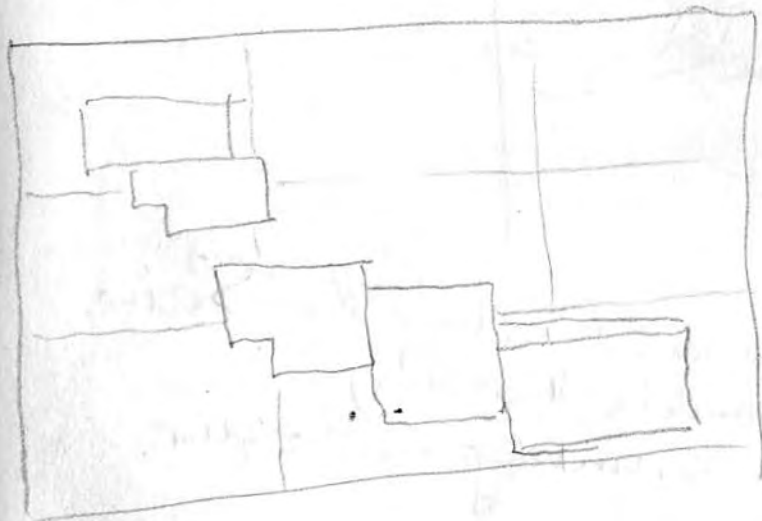



Bus road along the Seine
(Quai de la Mégisserie)
fish swimming in the air.

CONFORT
MODERNE

Hôtel du Pélican

6, Rue du Pélican - 75001 PARIS

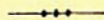

Métro : LOUVRE
PALAIS ROYAL

Tél. : 236-51-80

R. C. Paris 55 B 1323

BIBLIOTHÈQUE NATIONALE

DEPARTEMENT DES ESTAMPES ET DE LA PHOTOGRAPHIE

PARIS, LE

FRANÇOIS WODIMANT

Conservateur en chef

Estampes du XIX^e siècle.

58, RUE RICHELIEU, 75084 PARIS CEDEX 02 - TÉLÉPHONE 261.82.83

René Block:

DAAD.

Steinplatz 2.

1000 Berlin 12.

PZ (030) 310461.

Ezidio Alvaro

Diagonal.

10 Blvd Edgar Quinet.

Holding an Image

Screen ①

- rocks: glass
- = " X
- small marks
- + fragments of various colours. (yellow, red, silver).
- base colour of thumb.

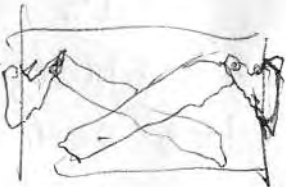

Screen ②

- rocks (mid shadow)
- " X
- thumb (mid shadow)

Screen ③

- rocks (full shadow) ^{transp} black
- " X + - yellow transp.
- thumb (full shadow)
- : : : holes in dense black (gloss)

Screen ④

Sky Blue.



Repaired Image

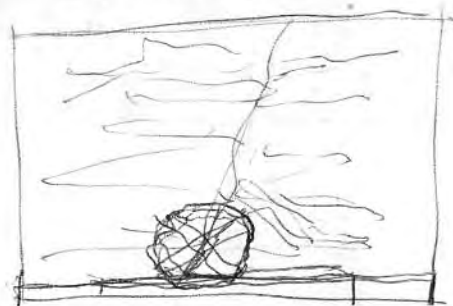

Finally printed in form of a boulder resting on its own (skeletal) infra structure.

Rock built up:
with 3 colours.

lower section:
Image from pos +
neg. superimposed

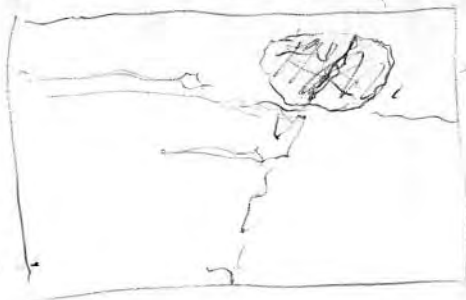

GRAND HOTEL PASCAL

L. LUCAS, PROPRIÉTAIRE

20-22, Rue Pascal, PARIS V^e

TOUT CONFORT - TEL. FOR. 43-82

R. C. SEINE 1.032.409

707

Petikan Hotel
Rue Petikan.

Roman Seiger.

Switzerland.



Examination of some
possibilities for wall works.

Use the Arches 80x120cm paper as
an approximation to the wall.

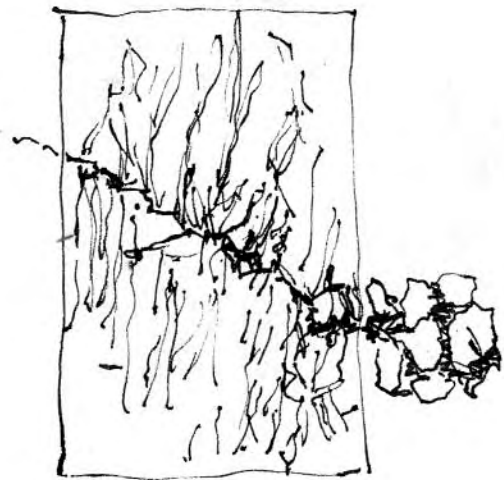
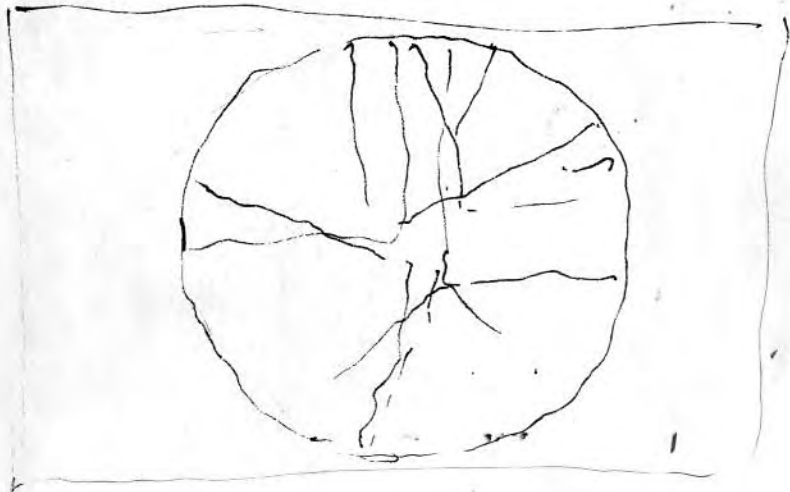

munich

Helmut Friedel / Labor Hall.

~~Adelmanns.~~ Lenbachhaus.

munich (689) 521041



Rohndorf.

plaster bandages.
 bucket water.
 dry plaster.



paper.

1. Clean roadway for paper.
2. Water on road.
3. Paper on road.
4. Dry plaster.
5. Onto chair.

Commence plastering.
 left leg. }
 right leg. }
 torso





~~Silent Cop.~~

3 lines in Rohrdorf

⇒ Check-point Rohrdorf.

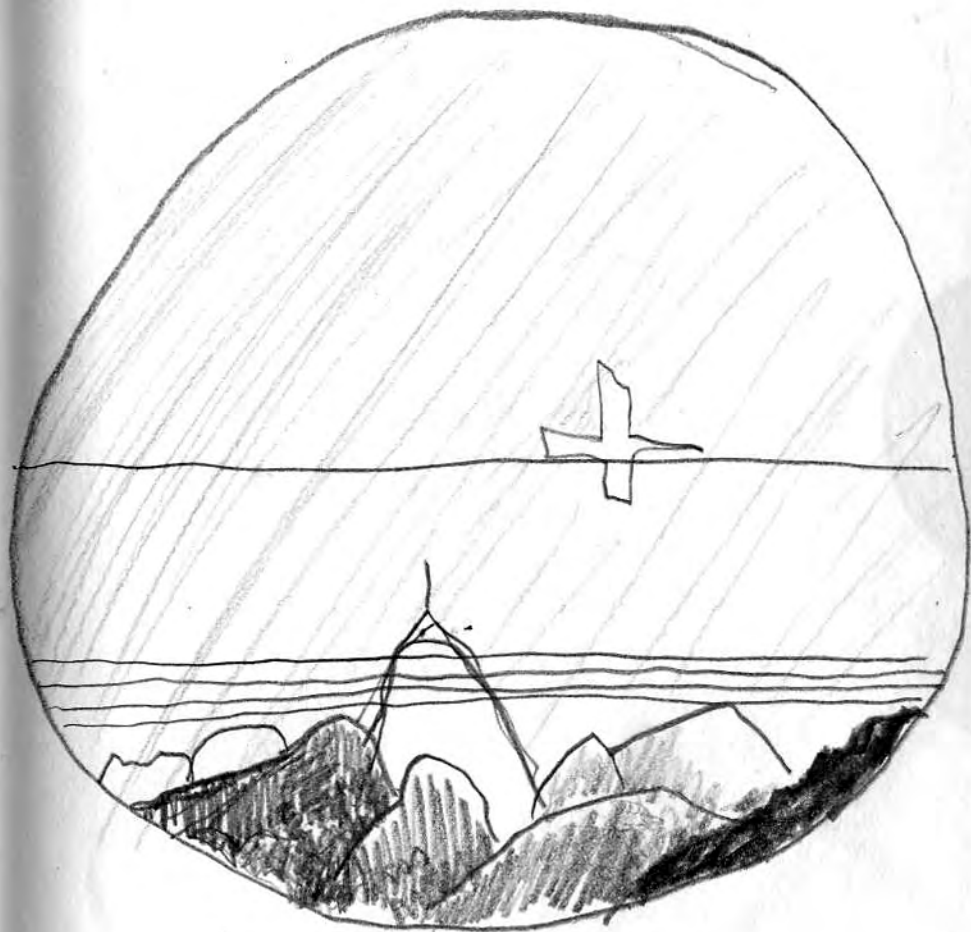

mountains + bird
from Rhodosp.



In St Gallen ¹⁰ 14 May.





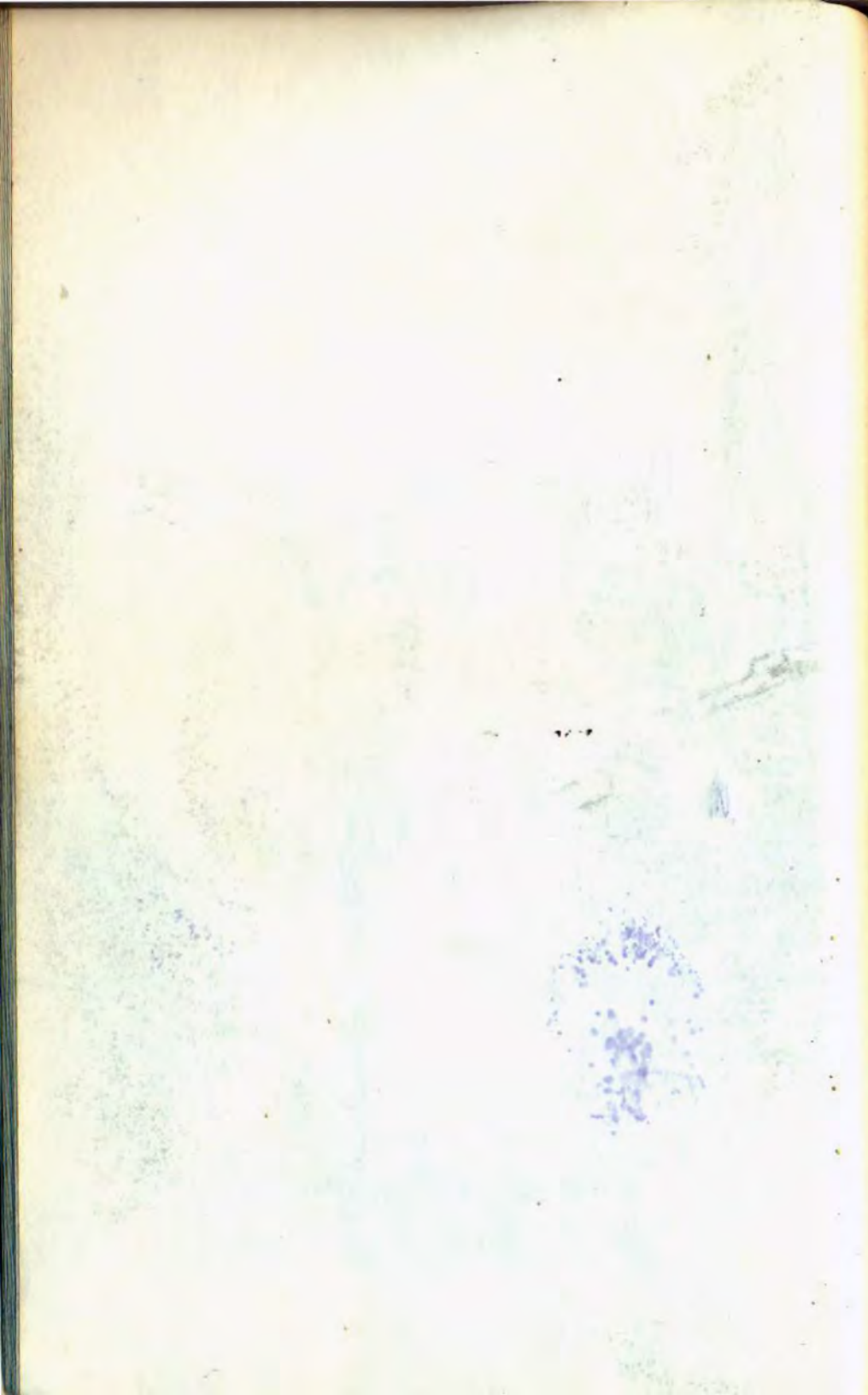

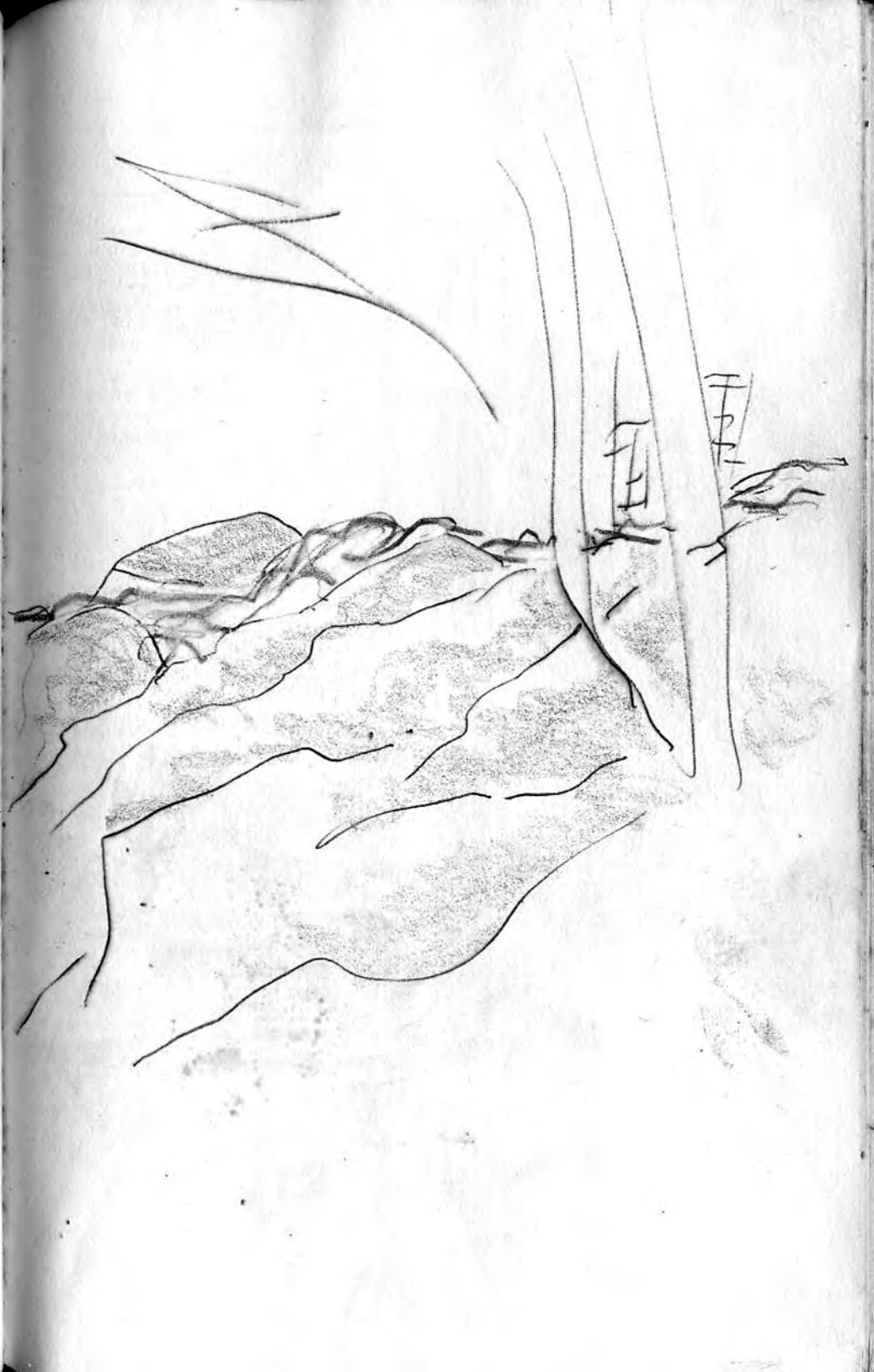
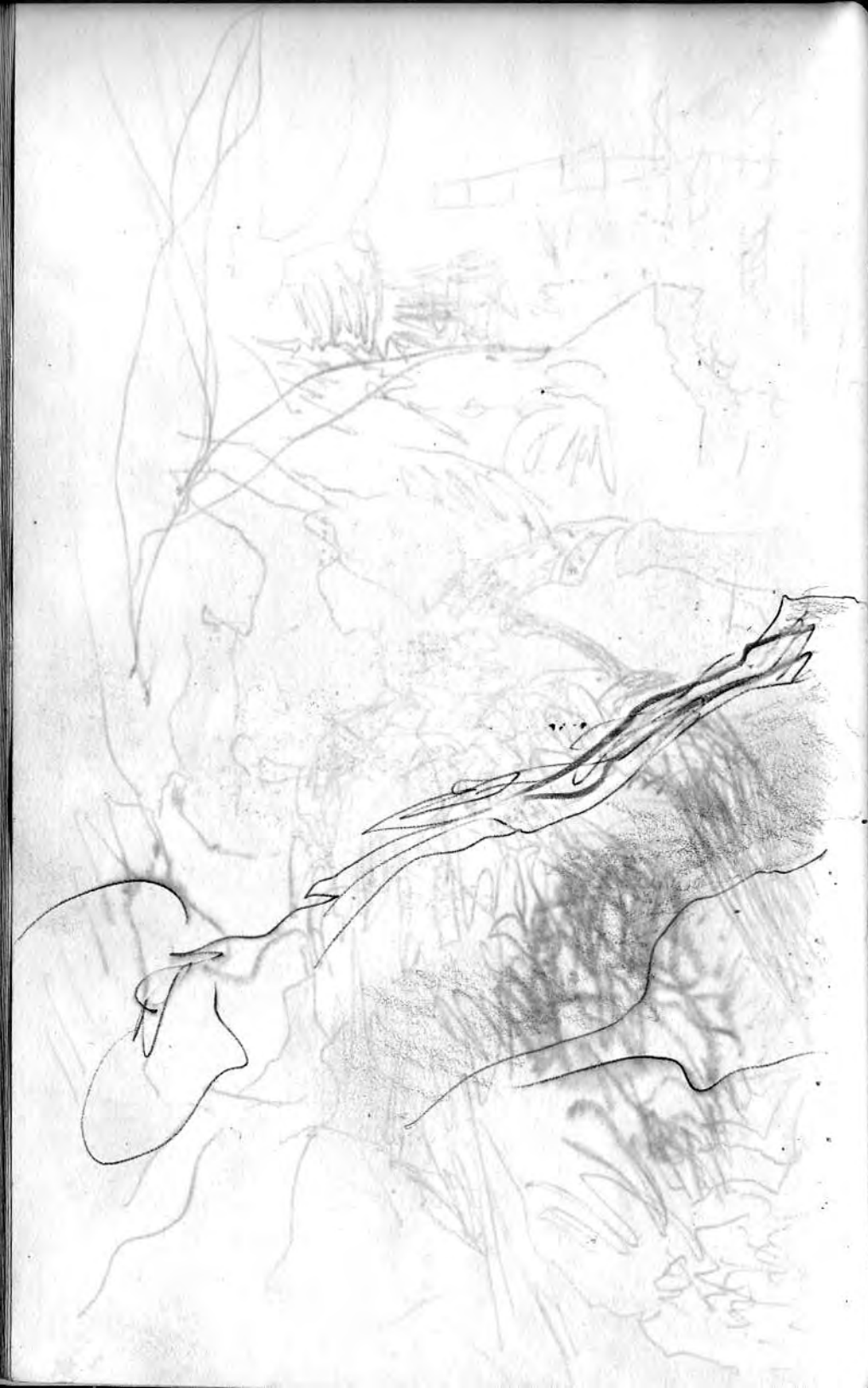



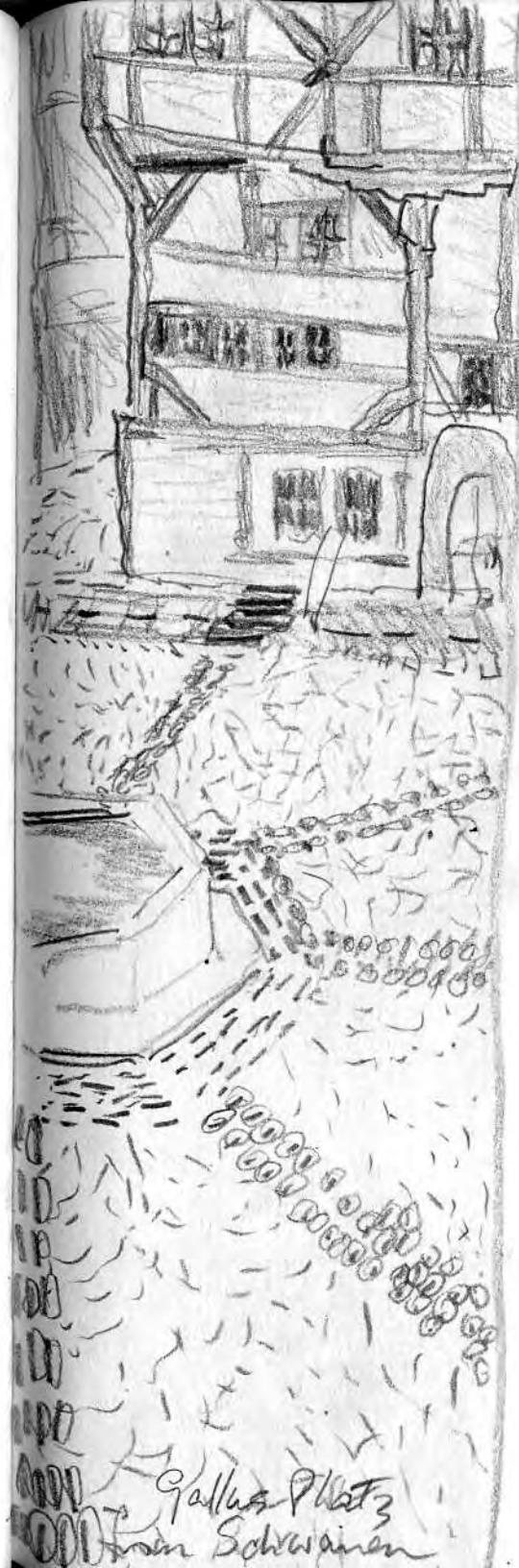

Gallusplatz
vom Schwarzen



14. Mai 1982



Waterwheels
Lucerne, May '82.



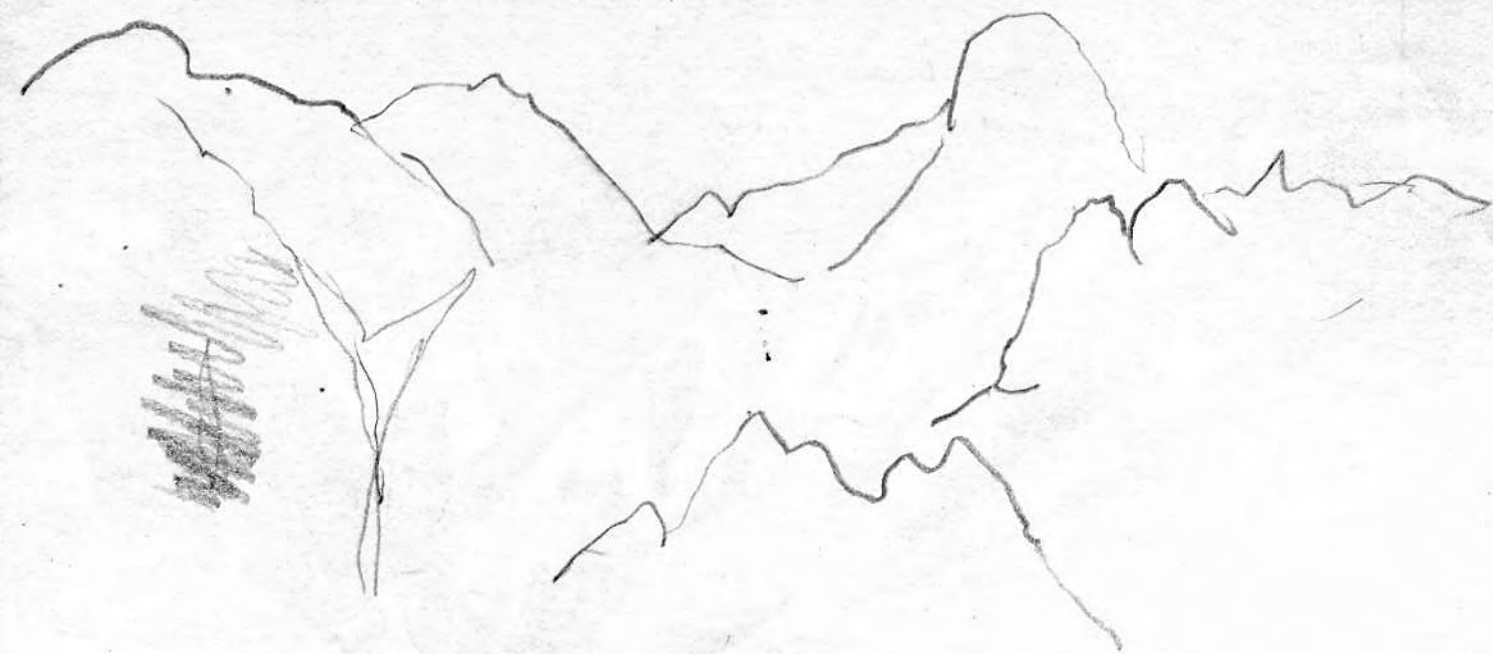

Museo
della Scala

Piazza della Scala 2, tel. 8053418; orario feriale:
9-12 / 14-18. Chiuso domenica

Pinacoteca
Ambrosiana

Piazza Pio XI 2, tel. 800146; orario: 9.30-17 (chiuso
sabato)

Pinacoteca
di Brera

Via Brera 28, tel. 808387; orario: 9-14; domenica
9-13 (chiusa lunedì non festivo). Sale visitabili: dalla 1ª
alla 38ª. In caso di carenza di personale la zona chiu-
sa va dalla 6ª alla 16ª sala. Modifiche d'apertura sono
segnalate all'ingresso

● Museo studio
F. Messina

Via San Sisto 10, tel. 871036 - Orario: martedì, gio-
vedì, sabato e domenica 9.30-12.30 / 14.30-17.30

● Museo
del Cinema

Via Palestro 16, tel. 799224; orario: 9-12.30 /
14.30-17.30 (chiuso sabato e festivi)

Museo delle Cere

Stazione Centrale, galleria delle partenze, tel.
272495; orario: dalle 8 alle 23.30 tutti i giorni

● Museo PIME

Via Mosè Bianchi 94, tel. 4980741; orario: da lunedì
a venerdì 8.30-12.30 / 14-18 (chiuso nelle festività).
Etnografia e arte orientale

● Museo
della Resistenza

Via Boifava 17, tel. 8460861, orario: da lunedì a ve-
enerdì 9-12 / 16-20 - Opere di Giuseppe Viola

● Museo della Chiesa
di Santa Maria
della Passione

Via V. Bellini 2, tel. 791370, orario: 10-12 /
15-17.30, domenica solo pomeriggio

● Herpetonzo

Via M. Bruto 19, tel. 711211 - Rettorario - Orario: sab-
bato 15-18, domenica 9-12, altri giorni riservati alle
scuole

● Ingresso gratuito

Per la **Pinacoteca di Brera** e il **Cenacolo Vinciano**
l'ingresso è gratuito: tutti i giorni per i soli cittadini
italiani al di sotto del 20° anno e al di sopra del 60°
e per tutti i minori di 12 anni purché accompagnati.

Alla Pinacoteca di Brera per tutti (italiani e stranieri)
il 1° e l'ultimo sabato e la 2ª e 3ª domenica di ogni
mese.

Al Cenacolo Vinciano per tutti (italiani e stranieri) la
2ª e 4ª domenica e il 1° e 3° martedì di ogni mese.

Prende il via l'Anno di Leonardo

Incomincia in questo mese di maggio il cosiddetto Anno leonardesco, cioè l'omaggio che Milano, a nome di tutto il mondo, rende al genio universale di Leonardo da Vinci nel cinquecentesimo anniversario del suo arrivo nel capoluogo lombardo. E incomincia con una serie di mostre: quella dei "Disegni delle collezioni reali di Windsor" e quella intitolata "Leonardo e la natura" nella Sala delle Asse, entrambe al Castello Sforzesco, oltre che l'esposizione del **Codice Atlantico** alla Pinacoteca Ambrosiana.

La Sala delle Asse e il Cenacolo sono le uniche opere di Leonardo di cui esistono documenti di commissione, ma egli lavorò a moltissime altre.

Leonardo visse a Milano **ben 25 su 67 anni**. La prima volta - presentata da Lorenzo il Magnifico a Ludovico il Moro come **suonatore di lira e uomo d'ingegno** - dal marzo del 1482 al settembre del 1499; cioè fra i 30 e i 48 anni, il periodo della maggior versatilità ed espressione delle sue eccezionali doti. Poi tra il 1506 e il 1507. Infine tra il 1508 e il 1513, richiamato dal nuovo governatore della città, il Duca d'Amboise, e dal Trivulzio, vincitore del "Moro", nel nome di Francesco I di Francia.

Fin troppo ovvio che, in tanti anni, il genio toscano abbia lasciato testimonianze a iosa della sua presenza in città e nel territorio dell'allora ducato, alcune arrivate fino a noi quali semplici toponimi (come gli **Orti leonardeschi**, tra Sant'Ambrogio, San Vittore e le Grazie, dove pare che Leonardo avesse delle vigne e una casa non distante da quella in cui aveva abitato Francesco Petrarca e che ancor oggi si può vedere a ridosso della pusterla), altre avolute nel fascino del dubbio (come **la casa di campagna** non distante dalla Vepra che Leonardo abitò, o avrebbe abitato, in quella che attualmente è **via Spagnoletto**: uno dei due immobili tuffati nel verde del civico 6), altre ancora tramandate in modo ambiguo (come **la Conca Fallata**, alla quale Leonardo mise mano per vani tentativi di correzione ma che non sbagliò lui).

Ma, oltre le testimonianze da lui lasciateci, quali altre "cose" vide Leonardo a Milano che ancora si possano ammirare in un ideale itinerario daviniano milanese?

Innanzitutto **le chiese, grandi e piccole**, di cui è sempre stata ricca l'area milanese.

S. Ambrogio, S. Lorenzo, S. Simpliciano, tutte del IV secolo come S. Eustorgio (che però fu rifatta nell'XI) e S. Nazaro Maggiore (che dopo un incendio fu ricostruita nel XVIII). Poi S. Calimero, che fu innalzata nel V secolo (e rifatta nel XVII) e S. Giovanni in Conca (ci restano i ruderi in piazza Missori) che è del VI, S. Vincenzo in Prato, S. Siro alla Vepra e S. Raffaele (più volte ristrutturata), S. Michele sul Dosso, S. Protaso al Lorenteggio (la cosiddetta Gesetta di Iusèrt); e S. Celso (rifatta nel XIX secolo), S. Satiro, S. Maria la Rossa sul Naviglio, che sono del X secolo.

Mood Gallery

Corso Monforte 23

Sino all'8, Erbari del 18° e 19° secolo

Ponte Rosso

Via Monte di Pietà 1a

Sino al 9, Perelli Cippo

Sant Ambroeus

Corso Magenta 22

Sino al 7, **Oronzo Corigliano**; dall'8 al 19, **Adriana Bevacqua**; dal 20 al 31, vincitori del **Premio di pittura e scultura "Polpet" di Belluno**

Studio A

Via Nirone 11

Sino al 9, **Costanzo Rovati**; dal 13 al 23, **Luigi Mella**; dal 27/5 al 6/6, **Francesca Cattoretti**

Velasquez

Via Pisanello 1

Sino al 6, **Valentino Legnani**; dall'8 al 20, Premio di Pittura **Rosetum '82**; dal 21/5 al 3/6, **Aloisa Barlassina, Luigi Fossati, Valentino Pizzi** - Orario: fienale 16-19.30, festivo 9.30-13 / 15-19.30

Zarathustra

Piazza San Marco 1

Sino al 6, **Licia Alberi** (pitture come grafemi)

Isola pedonale per "Week-end a Milano"

Per un intero mese, il centro di Milano sarà trasformato in una immensa "isola pedonale", tutti i sabato e domenica e, attraverso una grossa operazione organizzativa, saranno i pedoni ad essere padroni incontrastati di corso Vittorio Emanuele ed altre strade, oltre che di piazza del Duomo, della Galleria e di piazza della Scala. Sta, così, partendo la seconda edizione di "Week-end a Milano" che vede congiunti e concertati fra loro gli sforzi organizzativi del Comune, dell'EPT, dell'EPAM e di altri organismi cittadini.

L'anno scorso, l'iniziativa ebbe un indubbio successo di fruitori (anche se non mancò qualche mugugno e qualche critica) cosicché la manifestazione viene ripresa nel mese di maggio fino a giugno.

Quest'anno la manifestazione non si limita alla domenica, ma parte dal sabato per giungere alla domenica sera. Avremo i concerti di mezzogiorno (da tenersi in un cinema o teatro di corso Vittorio Emanuele); avremo spettacoli per bambini; ci sarà il mercato dei fiori, ci saranno mostre all'aperto e (forse) ancora il "risotto" sul sagrato del Duomo. Mentre sono allo studio, oltre ad esibizioni di "big" dello spettacolo, anche specifici spettacoli all'aperto per i giovani e i giovanissimi.

Insomma, si cerca di dare un volto più umano, una dimensione "pedonale" a un centro storico milanese per un periodo fra i migliori della stagione primaverile della nostra città

Fiere e mercati

Manifestazioni in programma nel quartiere della Fiera internazionale (tel. 49971)

dal 5 all'8

● EXPO-ITA '82 - Esposizione internazionale dell'isolamento termico ed acustico, delle coperture e dell'impermeabilizzazione - Ingresso da piazzale Giulio Cesare

● SIMAC '82 - Salone internazionale macchine per calzaturifici e concerie - macchine per la fabbricazione di accessori e prodotti sintetici - Ingresso da via Gattamelata

dal 6 all'8

● LINEAPELLE - Preselezione Italiana Moda - Ingresso da piazzale Carlo Magno

dal 7 al 10

● MIDO '82 - Mostra internazionale di ottica, optometria e oftalmologia - Ingressi da viale Cassiodoro e da piazza Sei Febbraio

dal 20 al 25

● INTERBIMALL '82 - Biennale internazionale delle macchine e accessori per la lavorazione del legno - Ingressi da piazzale Carlo Magno, da viale Eginardo e da via Spinola

● 8° SASMIL - Salone internazionale degli accessori e dei semilavorati per la fabbricazione e finitura dei mobili, degli imbottiti e dei manufatti di legno in genere - Ingressi da via Spinola, da viale Eginardo e da piazzale Carlo Magno

dal 21 al 25

● STAR '82 - Salone internazionale del tessile d'arredamento - tendaggio - tappeto - tappezzerie murali - stoffe per mobili e biancheria per la casa - Ingressi da piazzale Giulio Cesare, da viale Cassiodoro e da viale Boezio

● Ingresso riservato agli operatori economici

I tappezzeri in stoffa, i decoratori, i progettisti d'interni e i sellai di tutta Europa si riuniscono in congresso a Milano dal 20 al 23 maggio nell'ambito dello STAR '82 (Salone internazionale del tessile d'arredamento). La manifestazione assume un particolare rilievo e significato in quanto il congresso celebra solennemente anche il 25° anniversario di fondazione dell'E.U.T.D.S. (Unione Europea Tappezzeri, Decoratori-progettisti e Sellai), organismo europeo che riunisce gli operatori del settore.



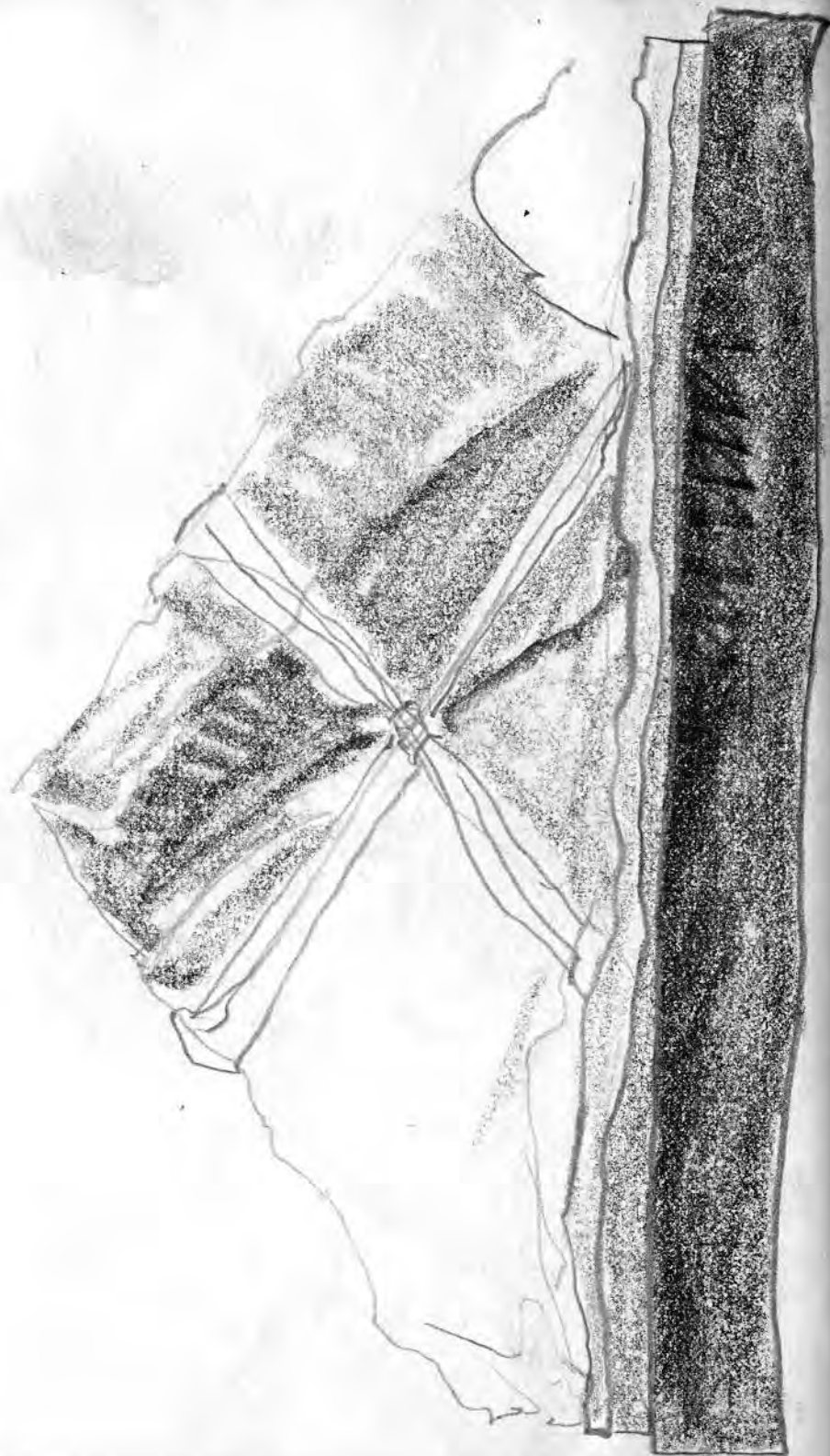

Bame. 17 May.

Bame closed for the day.
No art for viewing
except in the streets &
trams empty.
but window displays
in plenty.

2 ideas.

①



natural entrances —
eg. stone arches onto street
covered with wooden (or other material) & normal
doors substituted.

(2) From natural history display.



in a tiled white space, and stands on a plinth showing the traces of the object's making - spray paint.umps of plaster.

on the floor/walls: small traces of the object's making - stains of paint/prasid; liquids/spills of plaster.

[Faint, illegible handwriting on the left page of an open notebook.]









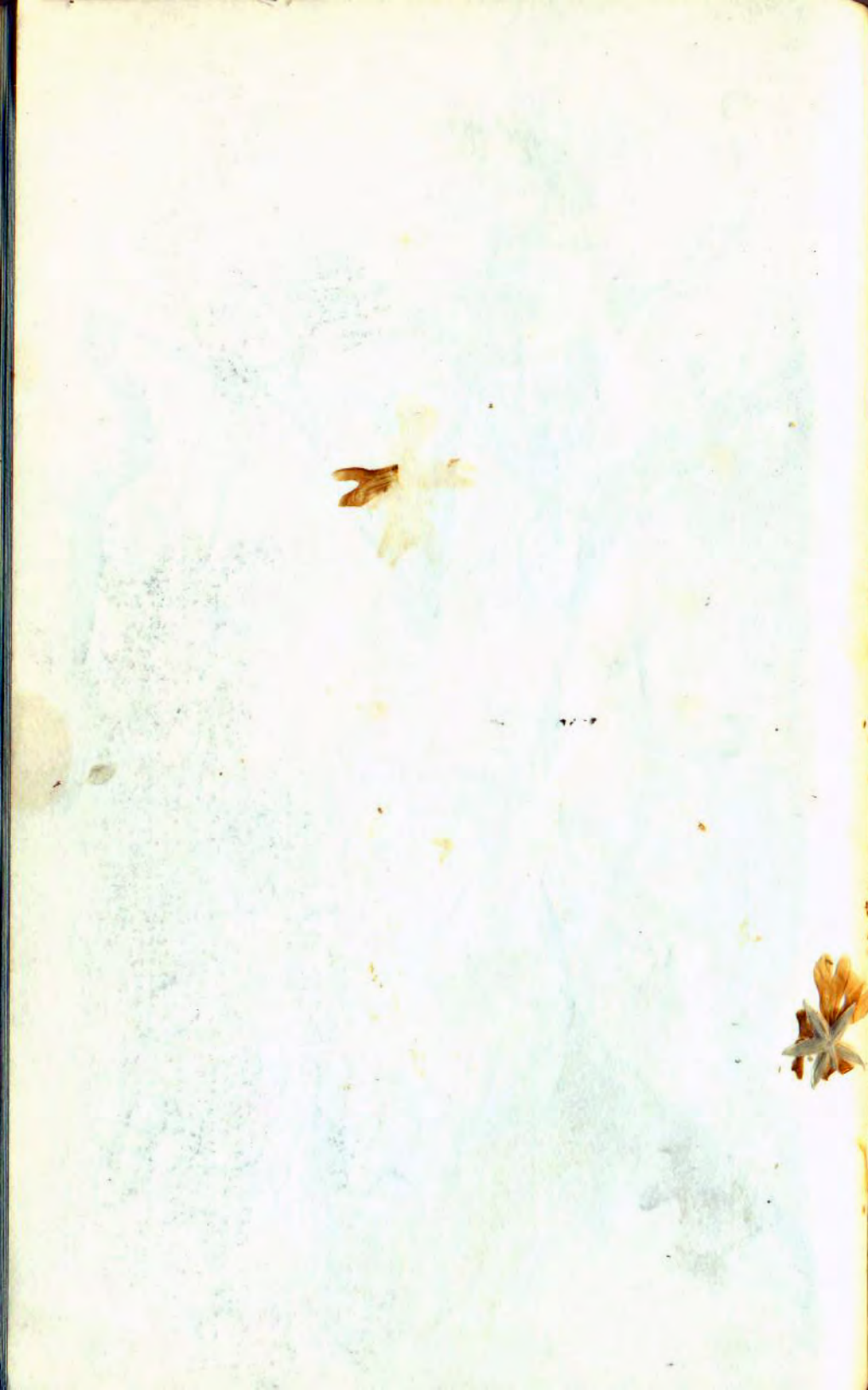



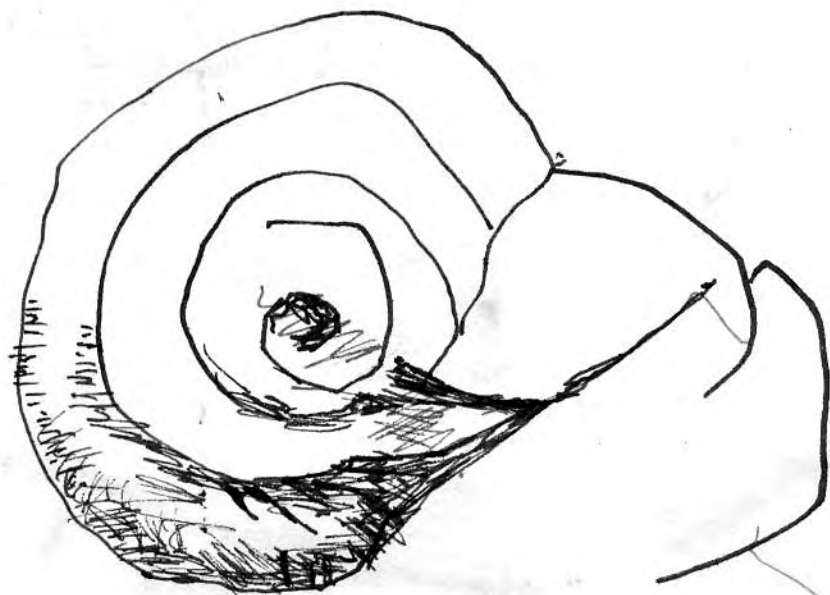





albergo
VILLA PARADISO
Via N. Tommaseo, 7
PADOVA - tel. 28.545

Uffizi - da Cosimo

Verrocchio (1435-1488) + da Vinci
"Baptism of Christ".

Scuola Toscana - Crucifix. *

Simone Martini ¹³⁴⁴ Annunciation.

Lippo Memmi. 1357.

Andrea Orcagna 1308-1368 The Story of sua vita.
Jacopo di Cione.

Luca Signorelli ¹⁴⁷⁰⁻¹⁵²¹ Coronation of the Virgin

Pere Magritte

1926. ~~di~~ i Complici del mago. 1

Paul Delvaux l'uomo della strada 1940
la nascita del giorno (l'aurora) 1937.

Magritte al sapore delle lacrime 1948.

Man Ray 46/53 le necessita della vita e le
conseguenze dei sogni.
al tempo delle caviglie.

1927. il giocatore segreto.

26 i complici del mago.

Fontana

Concetto spaa '57.

Galleria Bonaparte ✓

Canova - Bonaparte's lady

Benini. David.

Delpino + ~~de~~ Appollo.

Stape of Proserpine

Enca Archia + Ascario
1820.

Calrip (18-19)

Penna (13).

Pensione EVA

di LAMI MARINELLA

20124 MILANO
17, VIA LAZZARETTO
TEL. 632.898



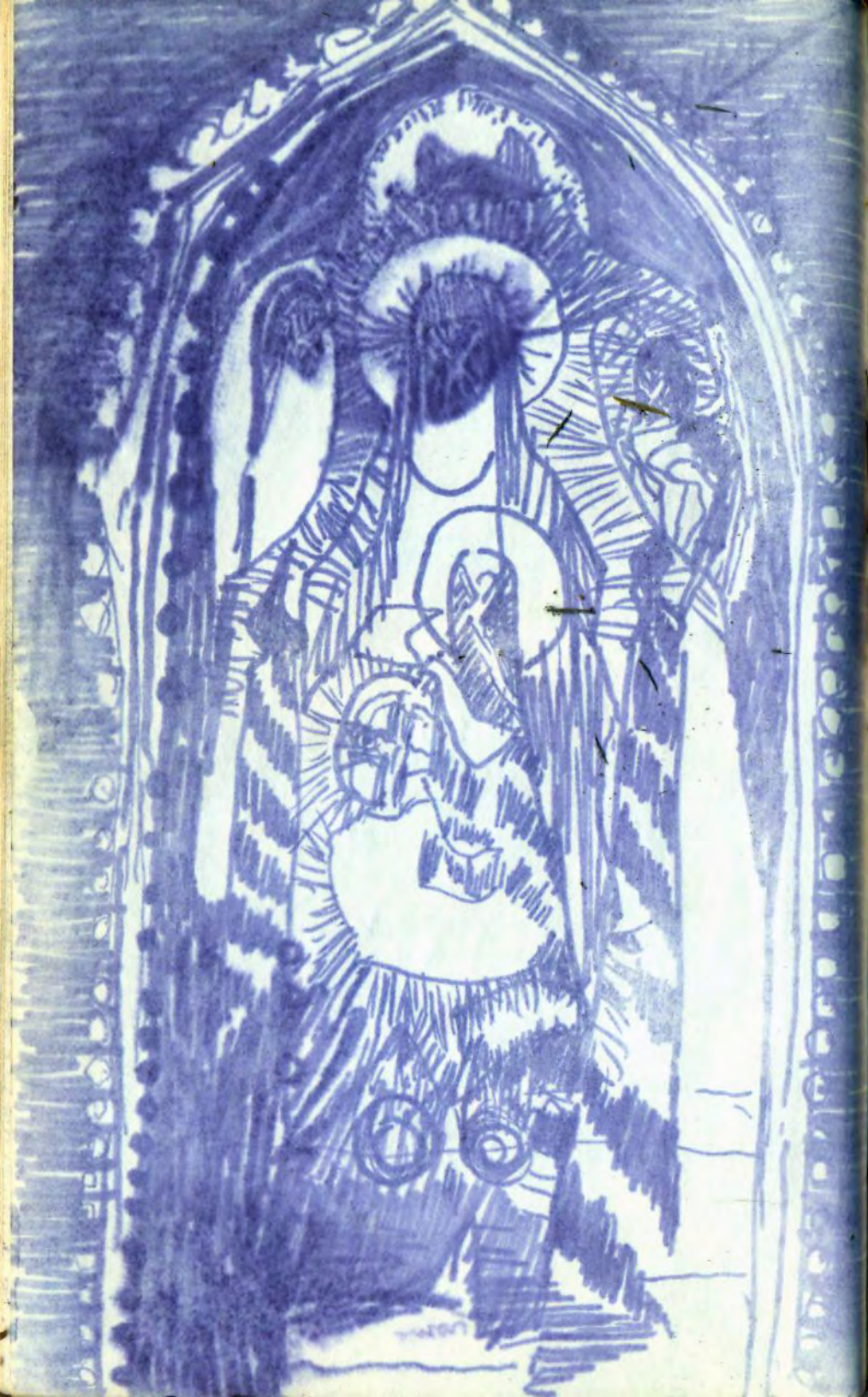

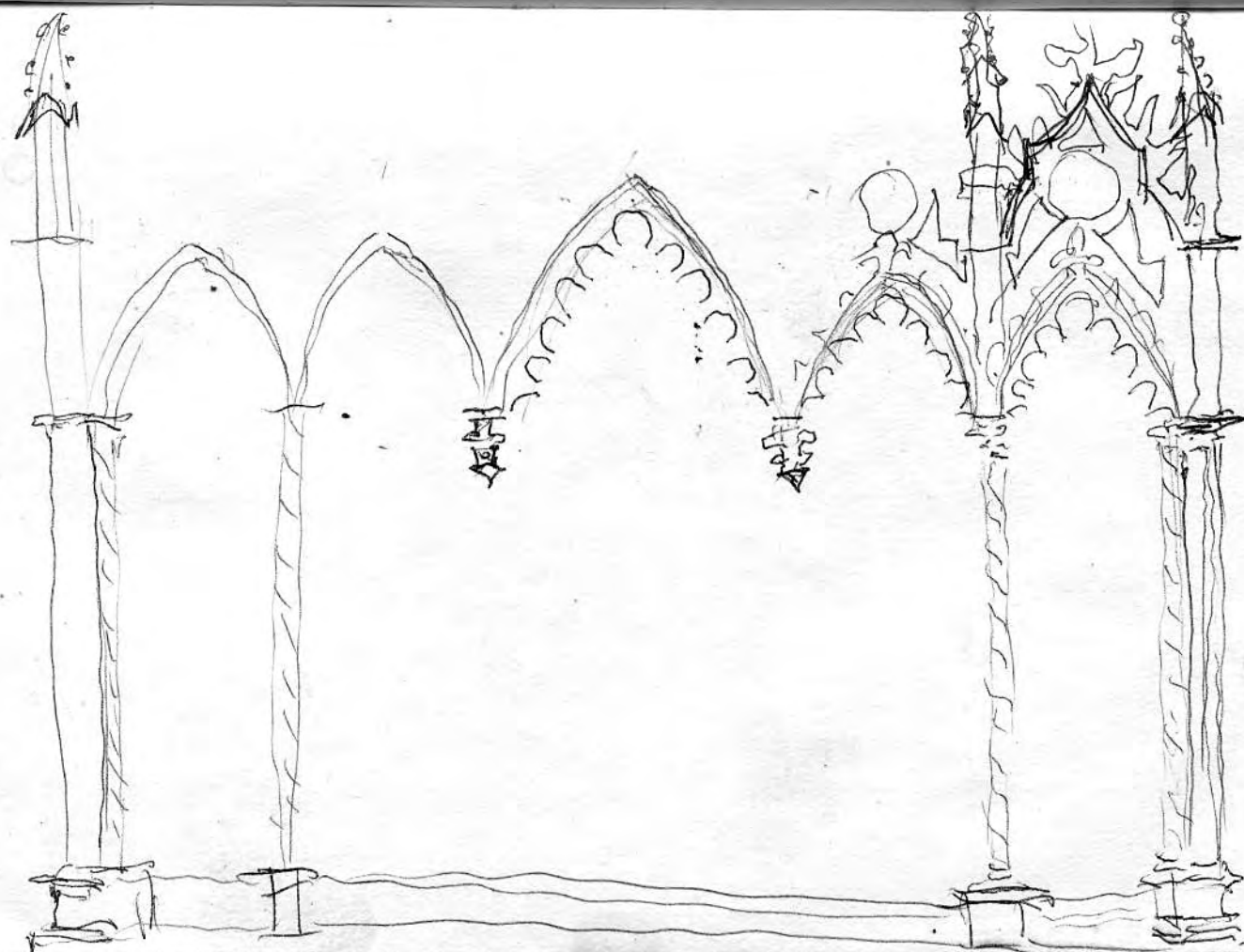



Olives
trees from
Fiesde May 27.



the
from
1849

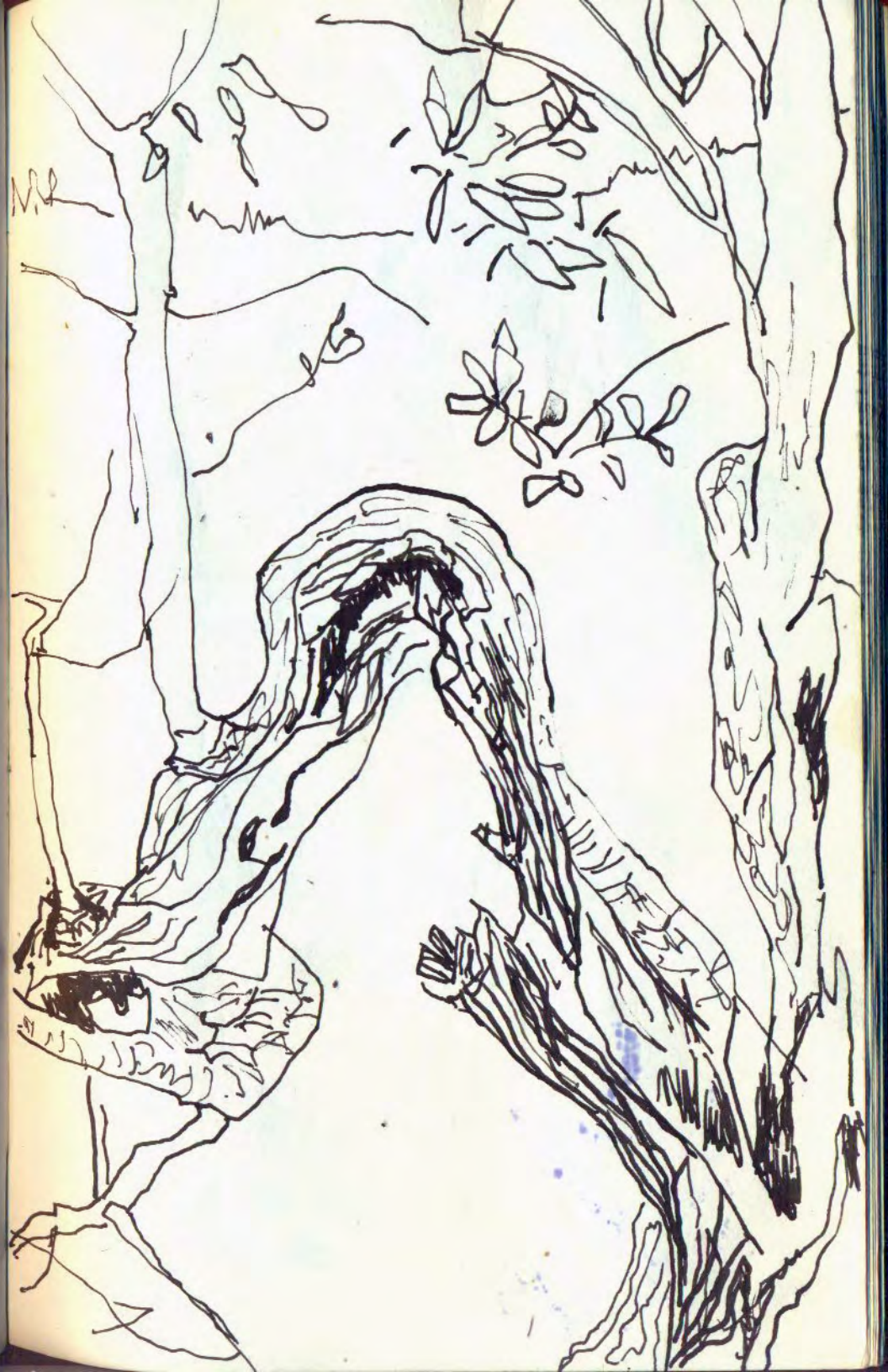

M.P.



Mountains between Rome + Pompeii.

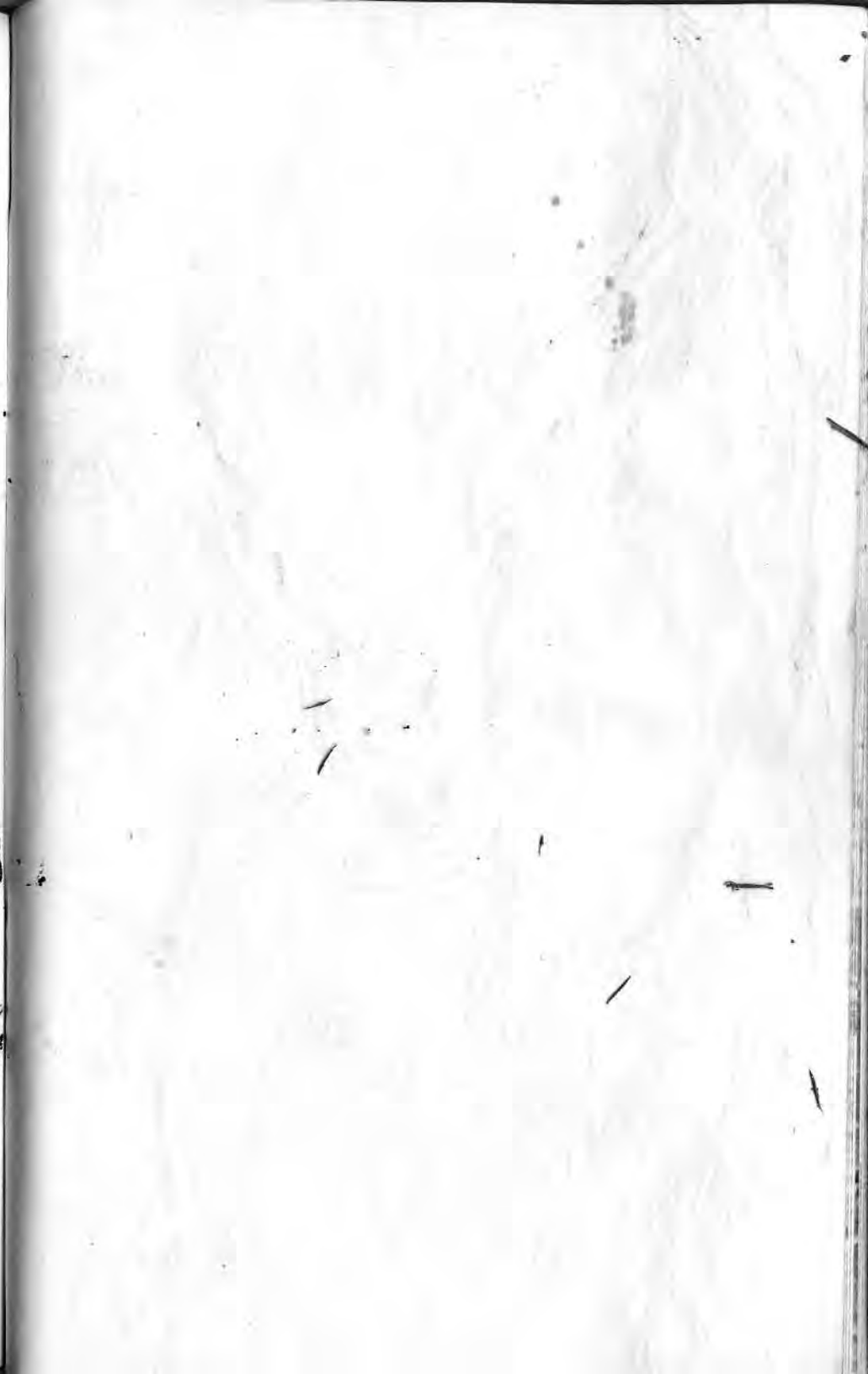



STAZIONE TERMINI

Albergo
APOLLO

RISCALDAMENTO
ACQUA CORRENTE
CALDA E FREDDA

ROMA
VIA DEI SERPENTI, 109

VIA TORINO
VIA FIRENZE
VIA PAROLI
V. AGOS DEPRETIS
VIA VENEZIA
VIA GENOVA
VIA MILANO
V. DEL BOSCHETTO
V. DEL SERPENTI

COLOSSEO

P. PONTECORVI ☎ 46 58 89

Cheap but good Pensione.
Rome.

ALBERGO APOLLO
di STRAPPAFELCI PIERA
V. dei Serpenti, 109
00184 Roma Tel. 465889
P. I. 00092860584

* AUGUSTO JACCARINO

Pellegrino,
via Belle Arti 8.
40126. Bologna.

2 June. Aix-en-Provence.

In the steps of Paul Cézanne.

- signs from the past.

look at these in the landscape.

Not St Victoire

Anarchy of Biveaux. (le cabanon de
Chateaufort (+ its pines) Biveaux)

+ Les Lauves + Tholonet

+ Jas de Bouffon.

3 June.

walk from Arc de Meyran to Port des 3 Sautets.



de Aix.

à Marseille.

X = 20

- but not so: 11 am.

ADAM

(M)

EDGARD
QUINET



RESEAU AUTOBUS AIX-EN-PROVENCE

1. ROTONDE / BEISSON
2. ROTONDE / ST DONNAT
3. ROTONDE / TROIS SAUTETS
4. ROTONDE / BEAUREGARD
5. ROTONDE / ARC de MEYRAN
6. LA TORSE / VERTE COLLINE
7. ROTONDE / ENCAGNANE
8. ROTONDE / JAS de BOUFFAN
9. BEAUVALLE / BELLEGARDE
10. VAL ST. ANDRE / JAS de BOUFFAN

* GARE ROUTIERE

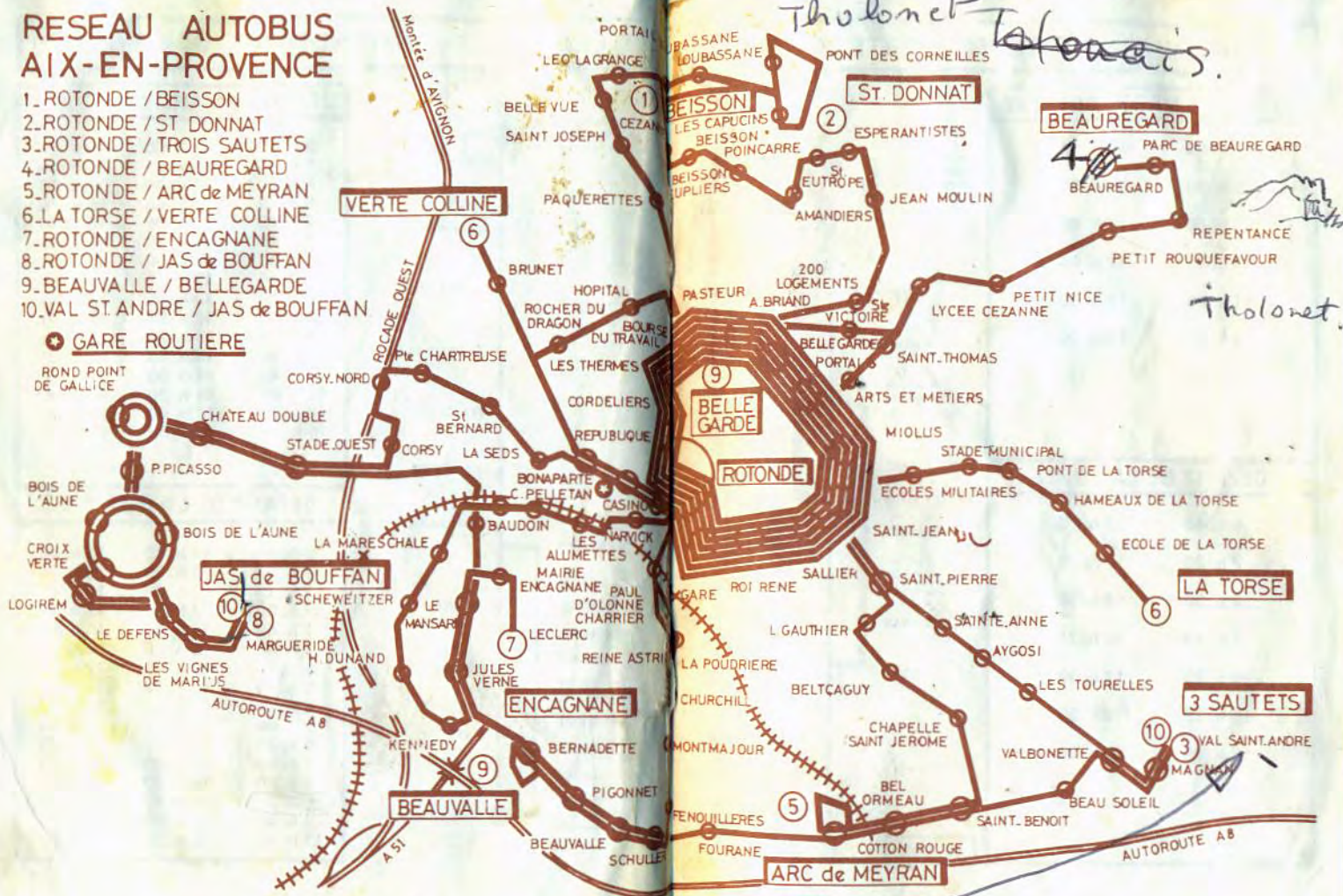

Tholonet Tahonais

Tholonet

all types { Knives
Scissors
Keys

PIETRO DOLCIMASCOLO

Affilatore specializzato

Lame di ogni tipo

Coltelleria - Ferramenta - Casalinghi

C.F. DLC PTR 28P28 Z352S

Via Cavour, 111 - Tel. 73.21.17

00184 ROMA

Italian or French.

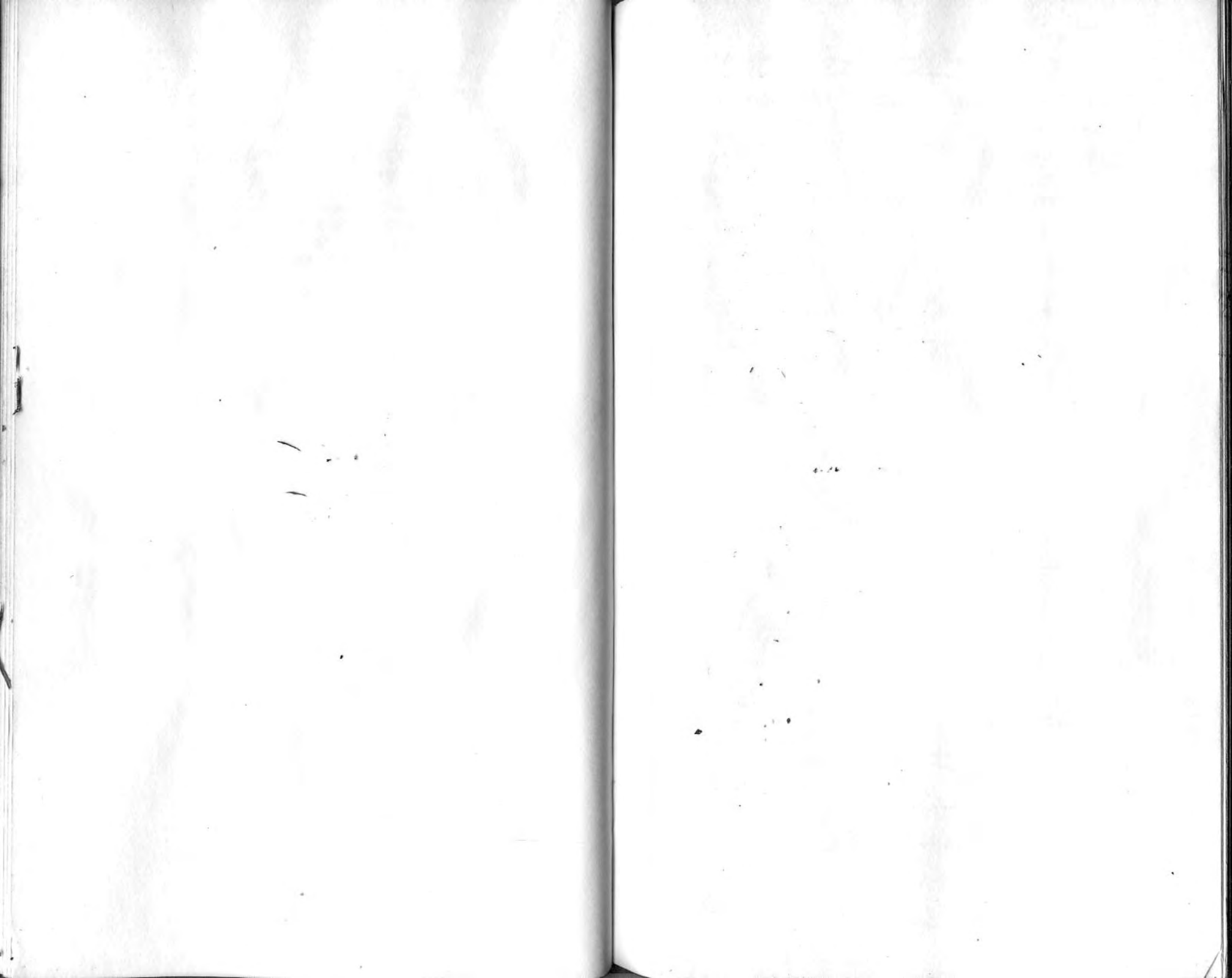

10 June

Documentation sent to:

1. Scottish Arts Council. (Hotel for demarco)
2. Giuseppe Bertolucci (Roma)
3. Giancarlo Pagliasso. (Torino)
4. René Block.
5. Olivia Bonito.
6. Ren Luigi Kurmann.
7. Tommaso Trini.

Phone: Julian Blaine
Suzanne Papp.

Envelopes
TTTT

-
- Milan: Tommaso Trini. (full). * V.S
- Rome: ~~Giuseppe Bertolucci. (San Andreas)~~
+ video.
- Rome: ~~Olivia Bonito (full)~~
- ~~Gianncarlo Pagliasso (full)~~
- ~~René Block (full + solstice)~~
- ~~Luigi Kurmann (full)~~
- + ~~Ren Vantier (full)~~
- Egidio - Diagonale. full.

Foreign Affairs.
For French Embassy.
Nor Bowden. (1)

Collected information from
Paul Carpenter - Cultural attaché
Aust. Embassy, Paris.

Bar Restaurant
L'AVENIR

24 RUE DE LA GLACIÈRE
75013 PARIS

 331 19 19

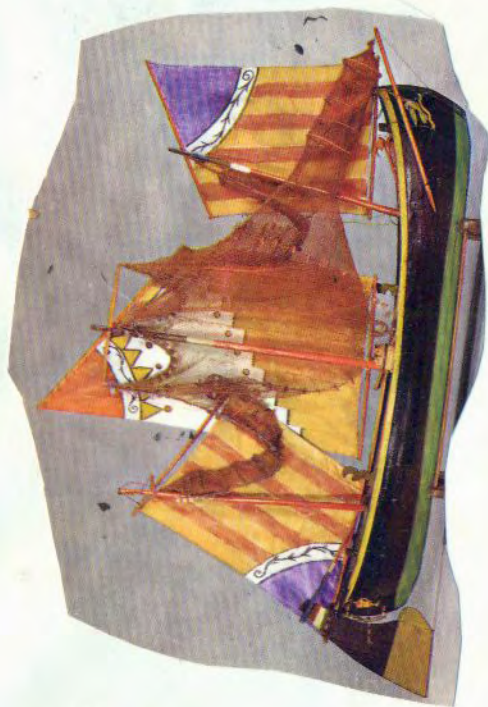



Wilhemstrasse 29

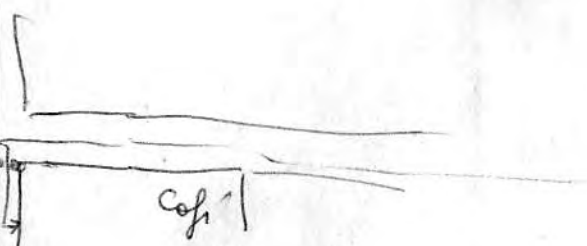

Paul McCarthy
1045 Rio Grande St.
Pasadena Ca.

91104

- Tel - 213. 798-8218

Wednesday 7th.

Franks. 5715 N. Figueroa St.

enlarger
focuser
liquid light

hit copy.

- editing gear.
- microphone - Radio Shack
- uv. ^{filter} for Canon. ✓
- film - super - 25 x 25.
- ^{cutadrome} - bulk.
- slide copier. → ?
- batteries (penlight). → ✓
- Roma Signar → 
- Paris copy service. ✓
- shadows for Nicky ✓
- 4 sets B/W. documentation ✓
- slides → colour Xerox ✓
- transfer. ✓

Radio Shack

400.

Los Angeles.

A SPACE FOR
espace dbd
NON-STATIONARY
ART

Giuditta Tornetta, Assistant Director
2847 South Robertson Blvd. Los Angeles, CA 90034
(213) 839-0661

A SPACE FOR
espace dbd
NON-STATIONARY
ART

Rachel Rosenthal, Director
2847 South Robertson Blvd. Los Angeles, CA 90034
(213) 839-0661

13 July

- Contact Honolulu. ✓
- Collect photo copied from Wilcopy. x ✓
- art material from Daniel ✓
- post off documentation. x ✓

Possible video venues

Media Study / Buffalo
207 Delaware Ave.
Buffalo, N.Y. 14202.
(716) 847-2555.

John Min Kousty.

The Kitchen.

Chicago Art Institute.

SWAMP. - Houston
(Rice Institute).

La Manuelle, } San Francisco.
V.F.A. }

N.W. Media Alliance.

15 July

D Bank = cash
= cheque acct + cards.
= post box + insure it.

11am LACE.

12 am lunch with Linda + Jon.

2 pm New Museum.

.. Collect espies from billcopy.

port of Documentation.

Departure for Honolulu.

Account from LA

Postage: 33 } 78
45 }
5

Phone.

Equipment ^{slide} + microphone 27
^{espies} + ^{reel} 100. 393
film 19 + 247 +

Car. petrol. 14 + 14 + 15 + 7 50

Consumable. 45 45

Photocopy. 5-17. 6

Plane 158:
20 180
757

Subscription to High Performance
+ 4 back issues. 31.

16
15
14

Performance etc spaces from
Giuditta Tornetta
Alternative Museum
17 White St.
NY, NY, 10013
Geno Rodriguez 212-966-4444

ARE Inc
513 Valencia St.
San Francisco CA 94110
415-863-0927
(Jan Heyner
Glen Scantlebury), (Linda
Giuditta)

CAGE
PO Box 1362
Cincinnati OH 45201
513-3812437
(Hudson)

Contemporary Art Inst. of Detroit
(CAID)
26260 Raine
Oak Park Michigan
48237
313-968-5112
Deanne Sperta

Fashion MODA
2803 3rd Ave
Bronx, NY, 10455
212-585-0135
(Lisa Kahane)

Franklin Furnace

Just above Midtown
178-80 Franklin
NY, NY, 10013

212-961-7090
Linda Good-Bryant

International Sculpture Center
10 Tenth St.
Oakland, CA 94607

(Eve Chung) 415-835-1991
644-2153

Portland Center for the Arts
117 NW Fifth Ave.
Portland, Oregon 97209
503-222-7107
(Dorina J. Milbrany)





4.13 pm. Circular Quay.
5.02 pm.
4.57 pm.
5.49 pm.



4.13 pm. Antiken Quay.
4.57 pm.
5.49 pm.



Ruth Prowse as at Sept 182.

- ① Signs of Presence. 4/17
- ✓ ② Page from Notebook 3/12
- ✓ ③ for Explorers A.P. V
- ✓ ④ Archimedes. 5/17
- ✓ ⑤ Against Tide with 7/17
- ✓ ⑥ Culminating S.M. 5/17
- ⑦ Absorption fac. 8/22

S.M.	I	II	III	IV
⑧	⑨	⑩		
AP VII.	12/20	12/20		
✓	✓	3	✓ #	

⑪ Calendar for 4 seasons. Drawing 2

Soo Bragança River Oct 2 1982



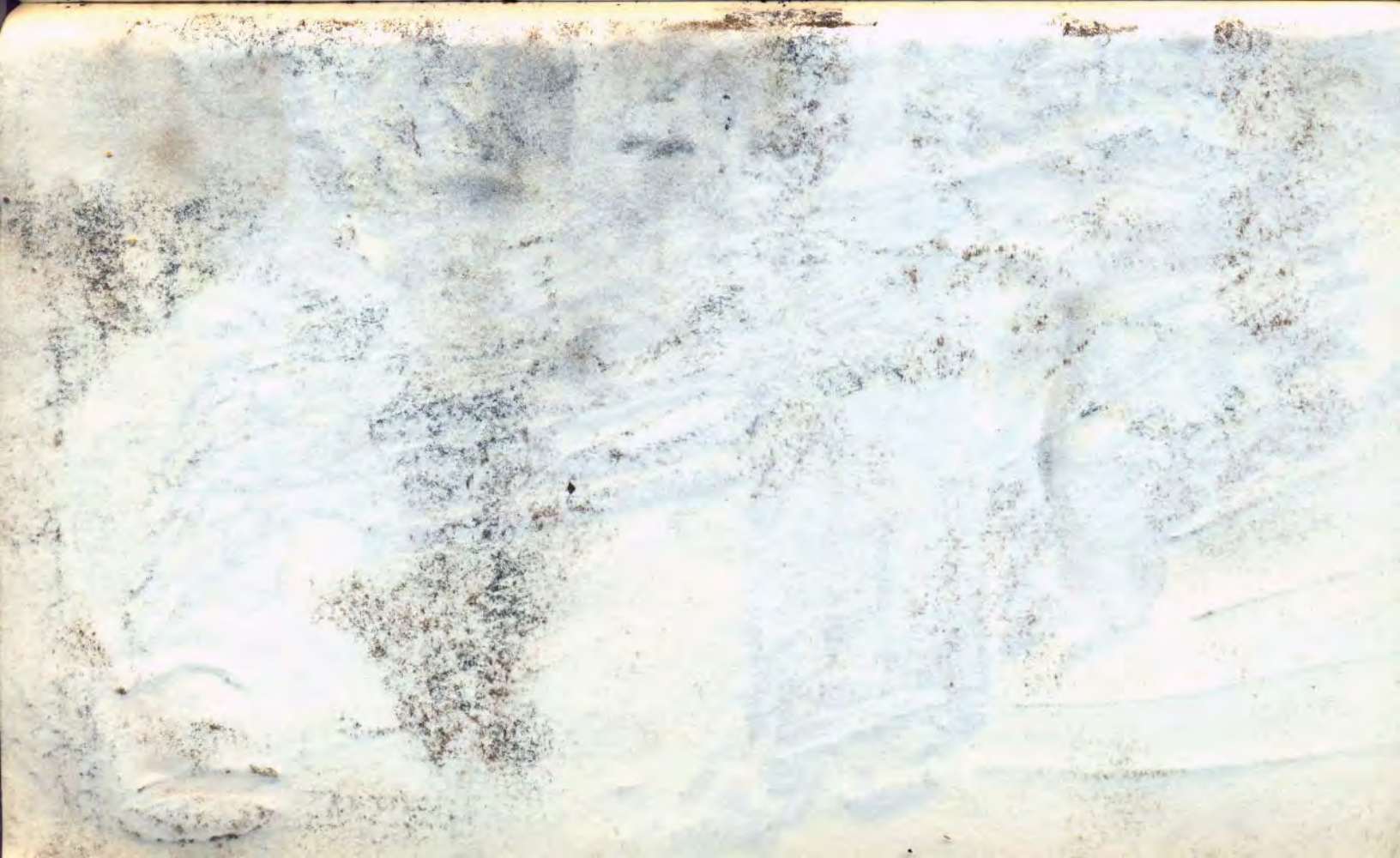

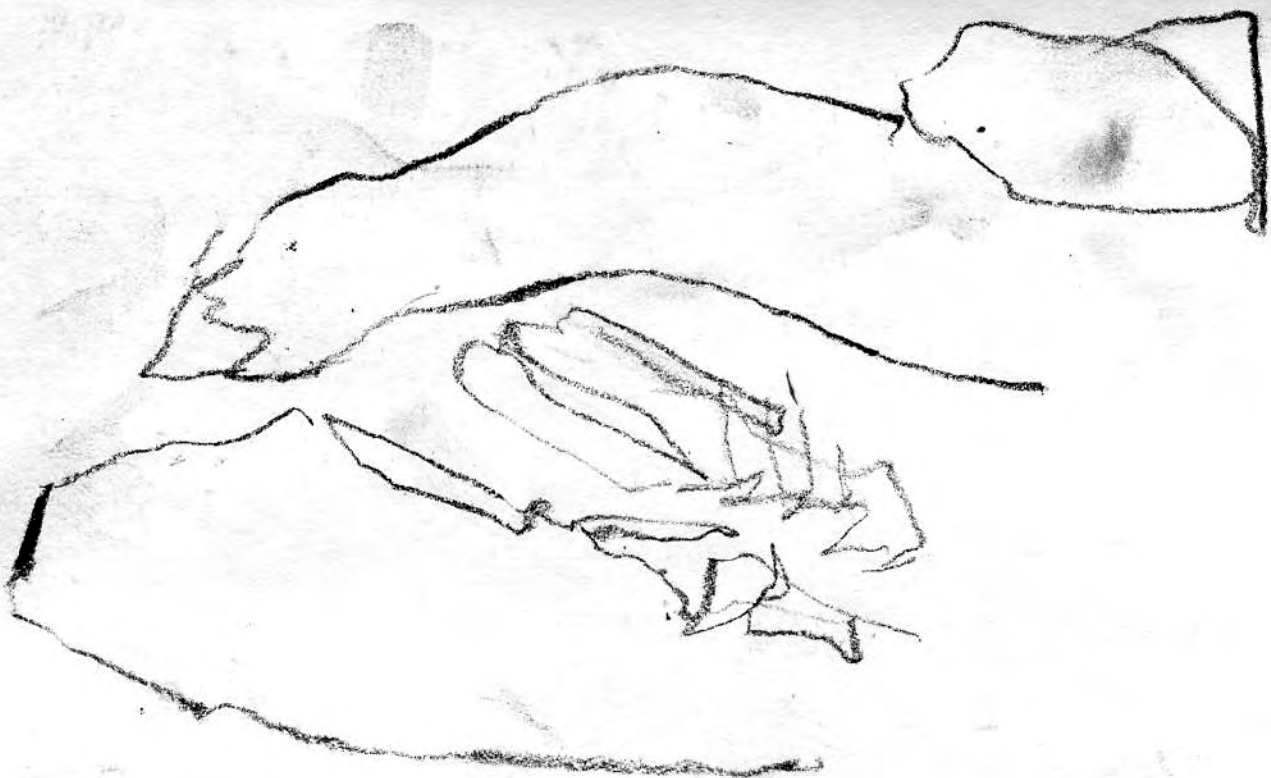
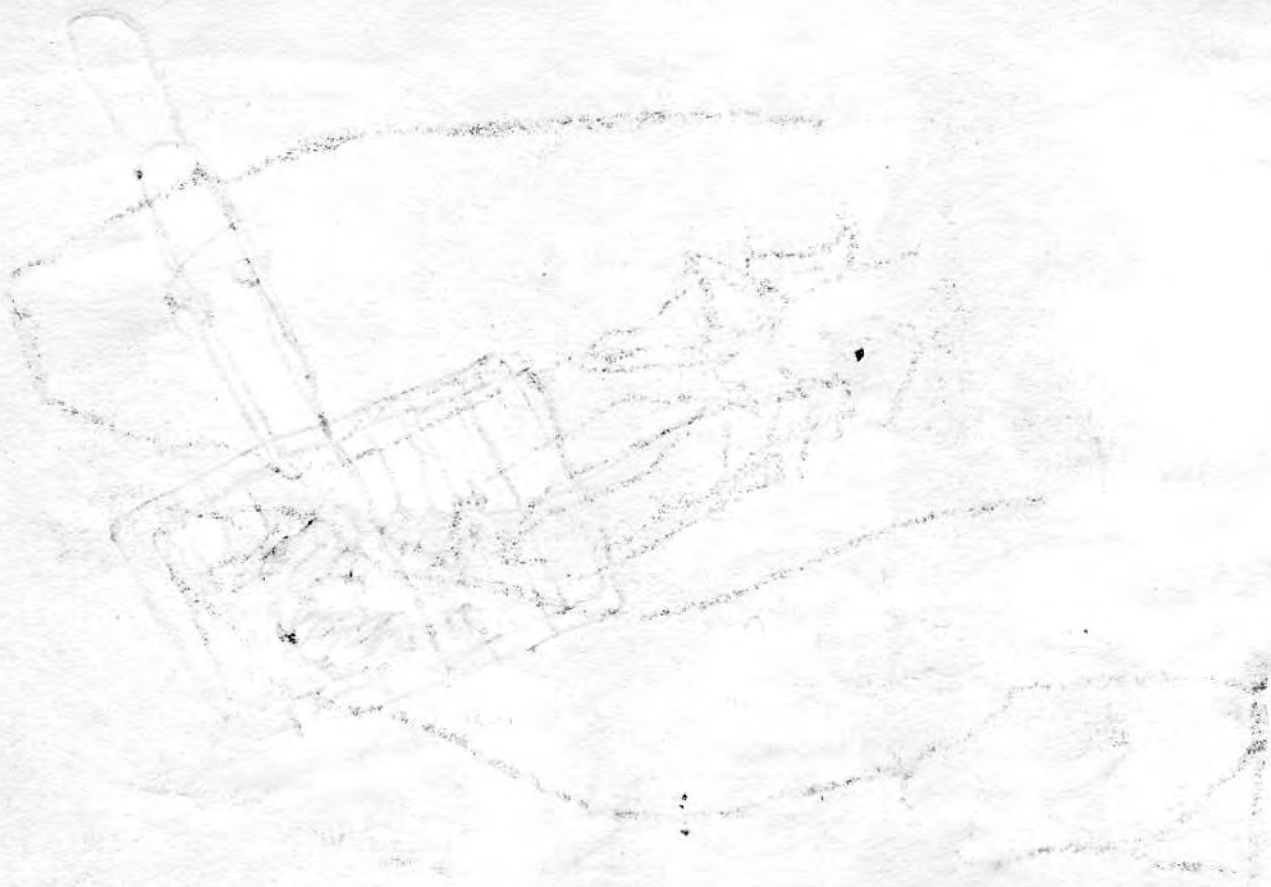







S. RAPOTEC
27 William Pt.
Double Bay. 2028
3281475



NATIONAL PARKS AND
WILDLIFE SERVICE

Geoff D. Spencer
DISTRICT SUPERINTENDENT

NORTH METROPOLITAN DISTRICT,
KURING-GAI CHASE,
BOBBIN HEAD, VIA TURRAMURRA.

TELEPHONE: Office - (02) 457 9322
A.H. Emergencies Only - (02) 457 9874

'DDART'

Ray Richards and Dennis de Groot
Ray ~~Rich~~ → 40 Maws Lane

Kimberley

Nottingham NG16 2JG.

UK. ph (0602) 389897
Nottm

Dan → 12 Marshwood house
West End Lane

Kilburn.

LONDON NW6.

ph (01) ~~624~~ 624 - 5986
London

Letters/Cards/ address.

- Warranbrook.
- Orange Festival of Arts
- Stuart Gerstman. ✓
- Newcastle Gallery. }
- Peter Haines. (Canberra School of Art.)

8/5

-
- T-shirt for Quince's show.
 - ~~At~~ Karen Dayman.
 - Shanel Forrest.
 - Sue
 - Bron ✓
 - Mum + Dad.

(8/5) Art forum: change address.

- Flash art. ^{change address +} ~~see~~ ² flash art / Art Visions for 1981/82
- refer other's experience.

- Linda Burnham
- deespare.

Quince

**SERIOUS
BUSINESS**

15 Randle Street, Sydney 2000.
2111471

Philip J. Selden

**SERIOUS
BUSINESS**

15 Randle Street, Sydney 2000.
2111471

**ROSLYN
OXLEY9**

roslyn oxley
gallery director

Tel 331 1919
13-21 macdonald st paddington 2021
tues/sat 10-6 or by appointment
art gallery • video • screening room

Larry Hanson.

School of Geological
Sciences.

Institutions to Contact
for Artist-in-Residency & Shows.

A-in-R.

- Columbus, Ohio. Ohio State Uni. (J. Baughman)
College of Arts.
190 N. Oval Mall.
Columbus Ohio
43210. (422) 6446.
Tel. (614)

- Uni. of Hawaii at Hilo Manua (Prof. A. Wade).
Faculty of Art at Manua.
2500 Campus Rd.
Honolulu, Hawaii.
96822
UH at Hilo.
1400 Katiolani St
Hilo. (David C.
96720. Purcell)

- Jerry McAllister.
Director - Mandeville Art Shows.
Mail Box. B-027.
U.C.S.D.
La Jolla. CA. 92093.

Mary Anne Goper. — Artist.
Dept of Visual Arts.
Box B-027.
U.C.S.D. CA. 92093.

Cincinnati Museum of Art. [Bob Stern] shows.
Contemp. Arts Center.
Eden Park. Circ. Ohio 45202

(Sebastian Adler).
La Jolla Museum of Contemporary Art.

University of Western Washington.
(Henry Gallery). EM Henley.
College of Arts & Sciences.
Seattle, Washington.
98195 tel. 15432100.

Under the personal supervision of the Proprietrix
Mrs Winifred Popplestone

ADELPHI-leonarde GUEST HOUSE

(CENTRAL—OFF VIEWFORTH)

BED & BREAKFAST

Central Heating - H & C - On-Street Parking

OPEN ALL YEAR

14 HARTINGTON GARDENS Res.: 031-229 6324
EDINBURGH EH10 4LD Private: 031-228



*Hébergement
chez l'Habitant
Bed and
Breakfast Office*

☎ 296 14 26
ou 256 37 47

Rue de Marignan, 23
75008 PARIS

Professional Photographic Color Laboratory



650 Howard Street, San Francisco, Ca. 94105 • (415) 986-6395

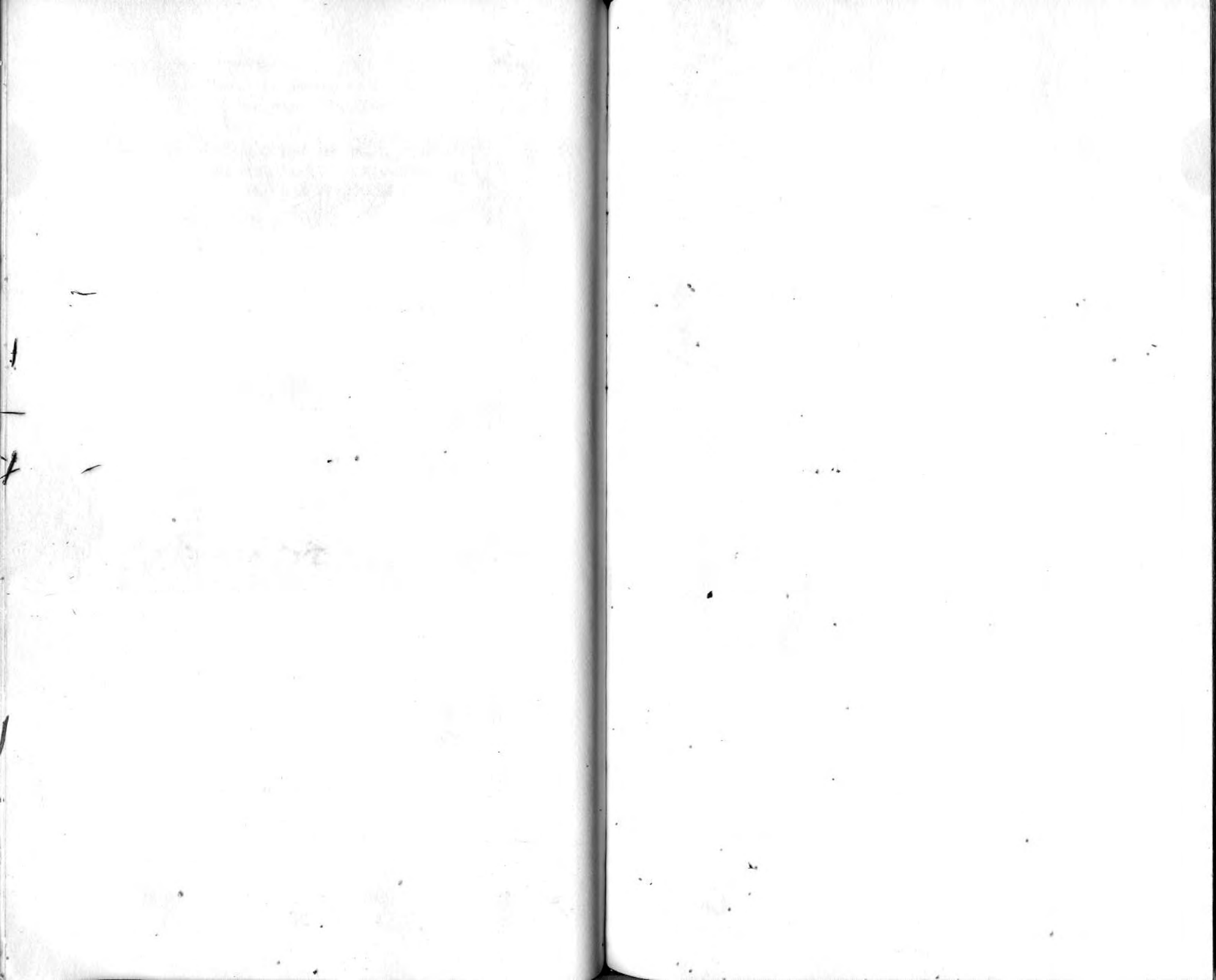





TOBACCOS ^{OF} HAWAII

1222 ALA MOANA CENTER
HONOLULU, HAWAII 96814
Phone 949-2826

PEARLRIDGE CENTER
Phone 488-8944

HAWAII'S TOTAL PIPESHOP

GFS-1270-C

A COLORFUL SUNSET IN JOSHUALAND

The fast diminishing Joshua Tree is one of the most spectacular botanical features of our western deserts. It belongs to the Lily family and attains heights up to 40 feet. The trunk has no annual rings, hence it is impossible to determine their age.

Photo by Ray Manley

Western Resort Publications, 1320 N. Broadway, Santa Ana, Calif.



ADDRESS

A rectangular area with rounded corners, divided into four horizontal sections by three dashed lines. The top section is labeled "ADDRESS".

Aerial Tramway
Palm Springs

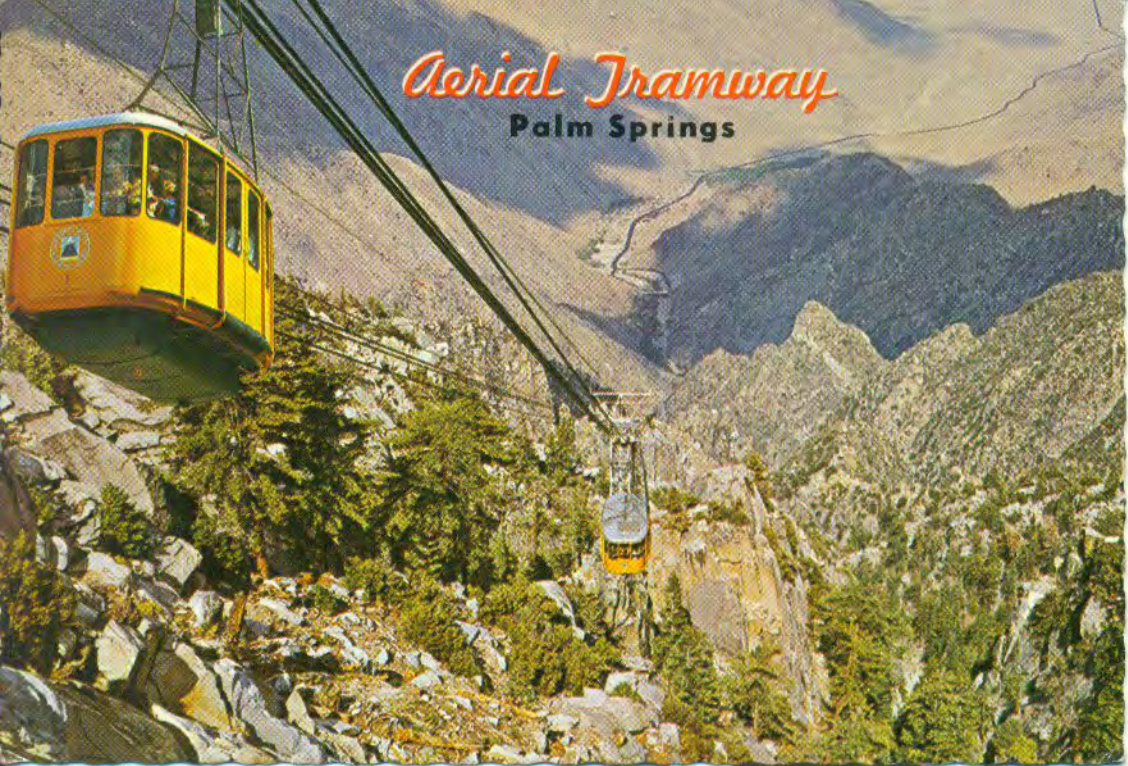

FS-929-C

AERIAL TRAMWAY
Palm Springs, California

The two 80 passenger cars about to pass at half-way point. The Valley Station (Elev. 2,643 ft.) is barely visible at the bottom of the canyon. This \$8,000,000 project was thirty years in the planning and required two years to build.

Color by David M. Mills

Western Resort Publications, 1320 N. Broadway, Santa Ana, Calif.



ADDRESS

A large rectangular box with rounded corners, divided into four horizontal sections by three horizontal lines. The top section is labeled "ADDRESS".